



Triumph Tiger 1200
SP Connect Sat Nav Mount

Installation Instructions

Kit Contents PRN014516-014677

- (A) 1 x M6 x 16 Countersunk Screw
- (B) 1 x Pivot Plate
- (C) 1 x SP Connect Plate
- (D) 2 x M5 x 10mm Button Head Bolts
- (E) 2 x P-clips (No.1)
- (F) 2 x P-clips (No.2)
- (G) 2 x P-clips (No.3)
- (H) 2 x P-clips (No.4)
- (I) 2 x Lobe Screw
- (J) 2 x Locking Washer
- (K) 2 x M5 Black Washer
- (L) 2 x M4 x 5mm Button Head Bolts
- (N) 4 x Spacer

Sub Kit



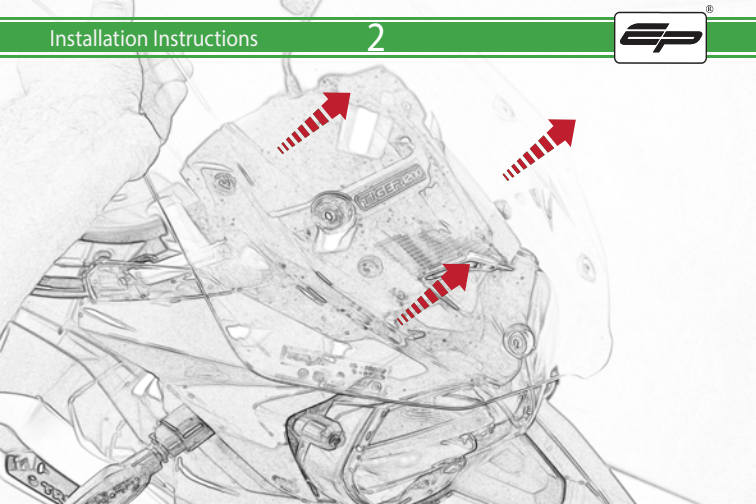



SP Connect
Standard Mount



SP Connect
Anti Vibration Mount



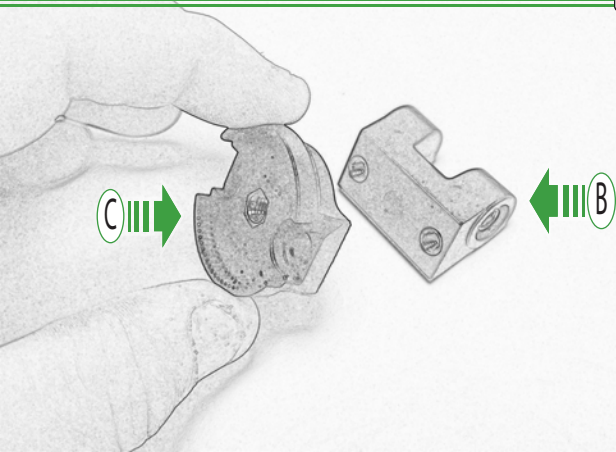



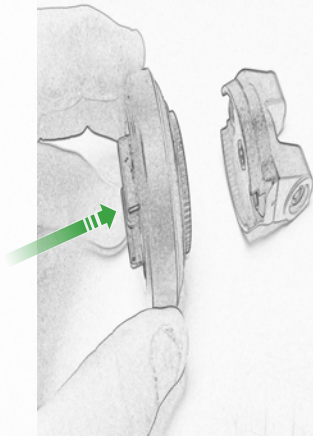
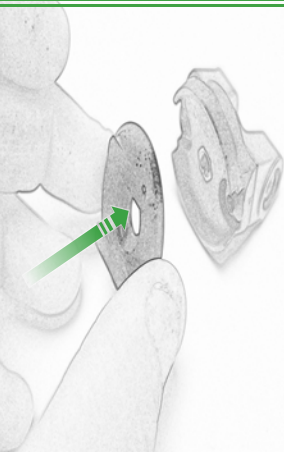

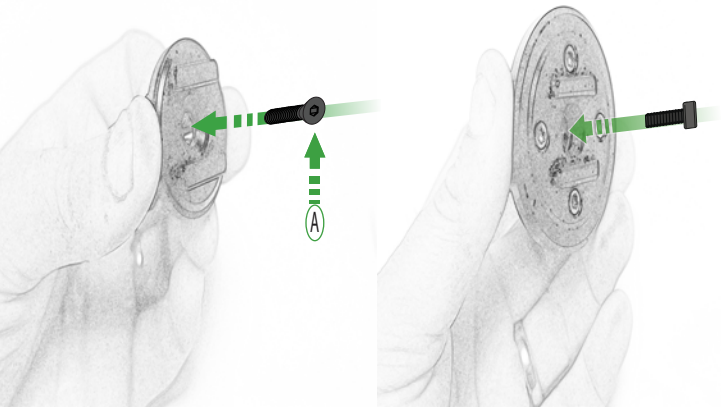





Repeat
Both Sides

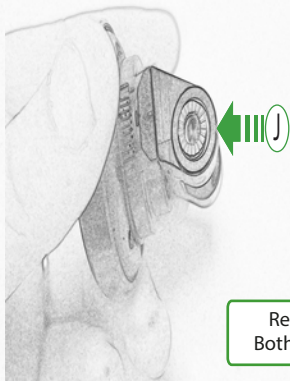

Repeat
Both Sides

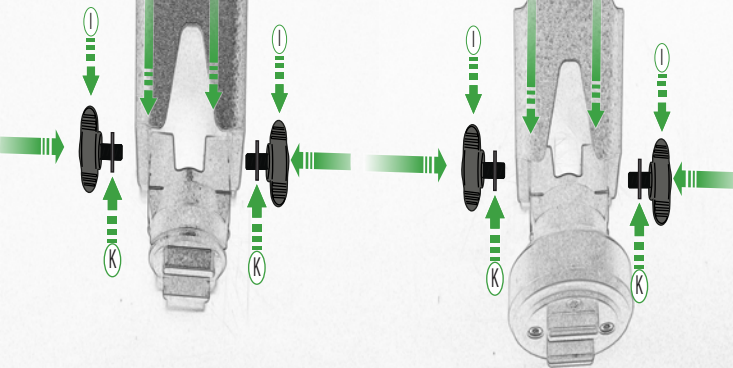

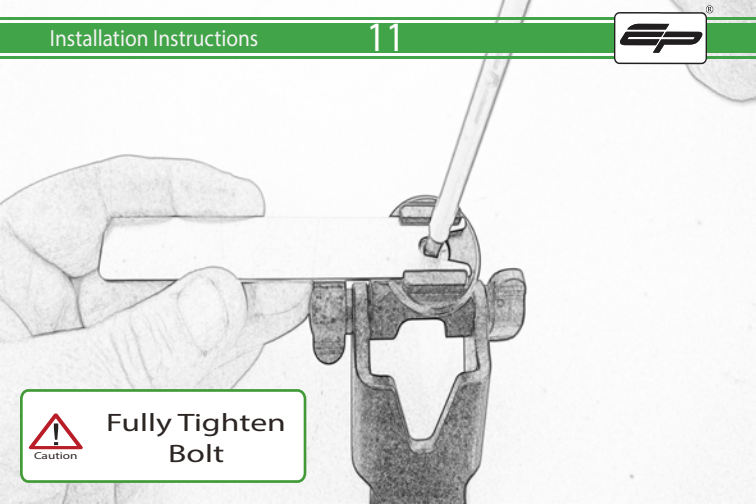

Caution

**Fully Tighten
Bolt**

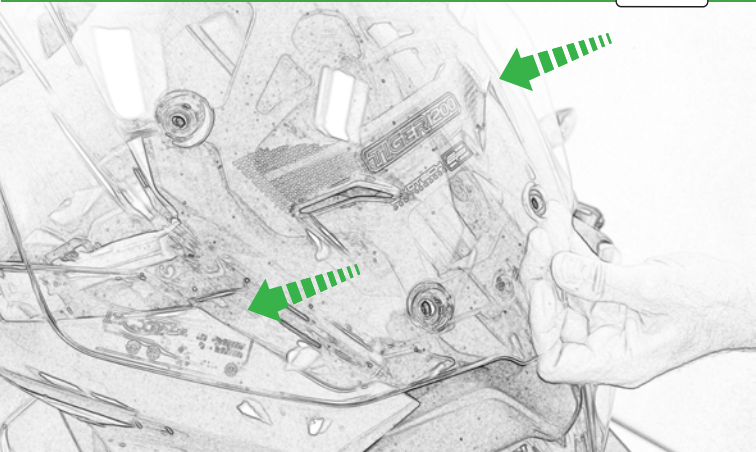

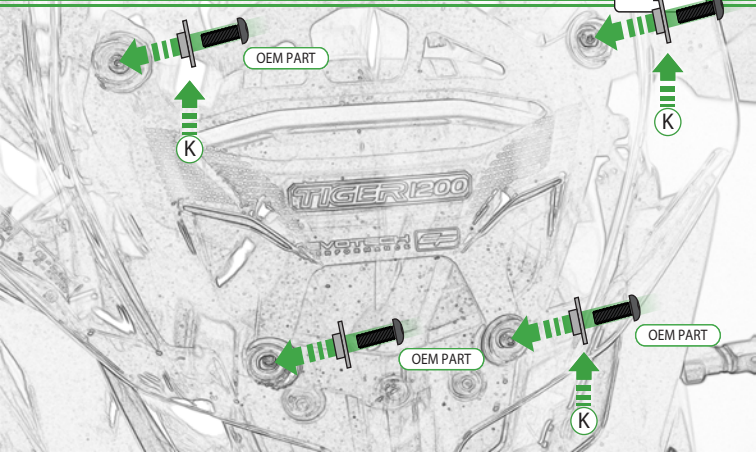

OEM PART

K

K

OEM PART

K

OEM PART



ESSENTIAL CHECKS



It is recommended that periodic inspections are made to ensure that all bolts are tightend to the specified torque settings.

Should the bike be involved in an accident a thorough inspection should be made and any components that have taken an impact, no matter how small, be replaced



EVOTECH®
P E R F O R M A N C E

www.evotech-performance.com