



Kawasaki ZH2
SP Connect Sat Nav Mount

Installation Instructions

Kit Contents

- Ⓐ 1 x M5 x 12 Countersunk Screw
- Ⓑ 1 x Pivot Plate
- Ⓒ 1 x SP Connect Plate
- Ⓓ 1 x Mounting Bracket
- Ⓔ 2 x Nord Washer
- Ⓕ 2 x M5 x 10mm Button Head Bolts
- Ⓖ 2 x M5 x 12mm Caphead Bolts
- Ⓗ 2 x M5 Washer



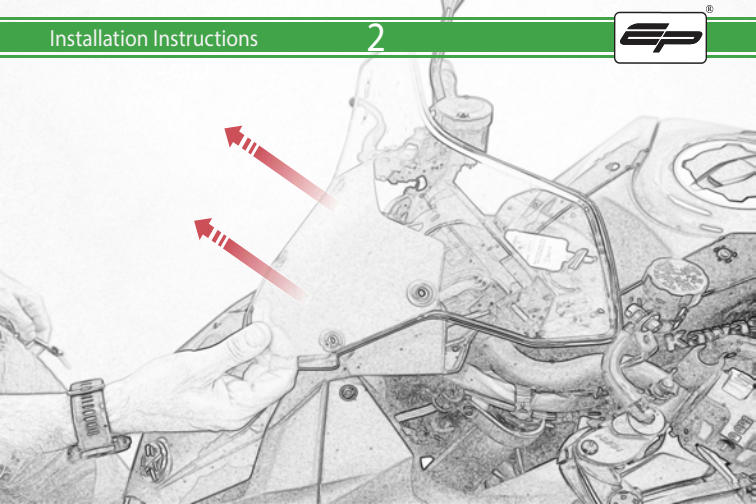

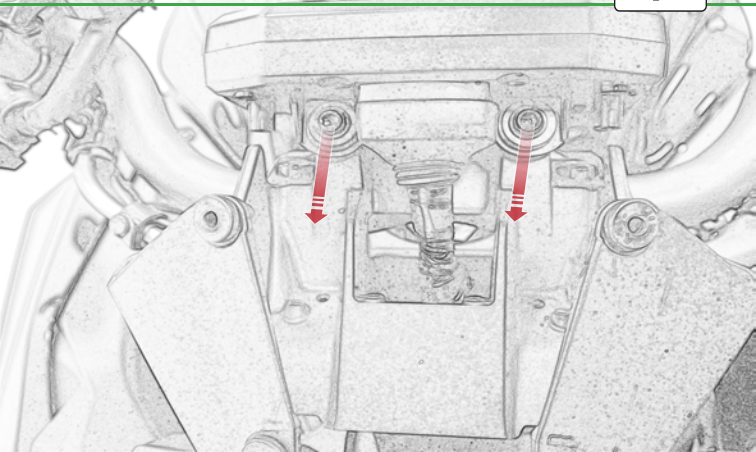

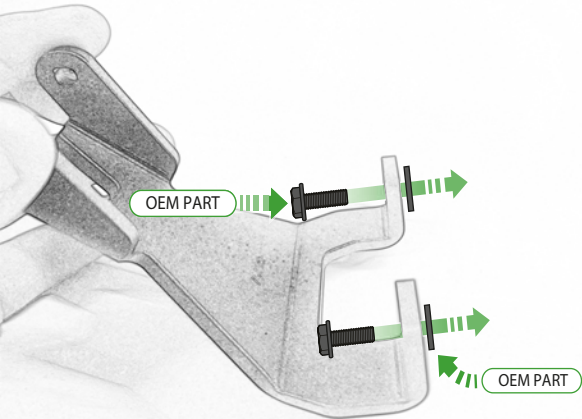

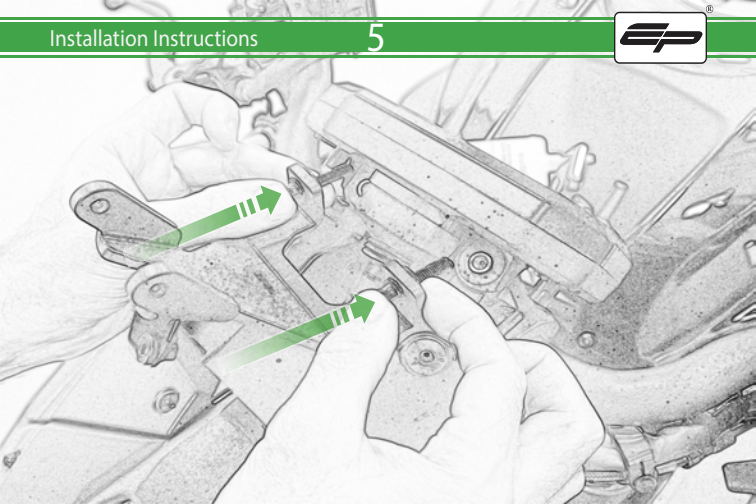

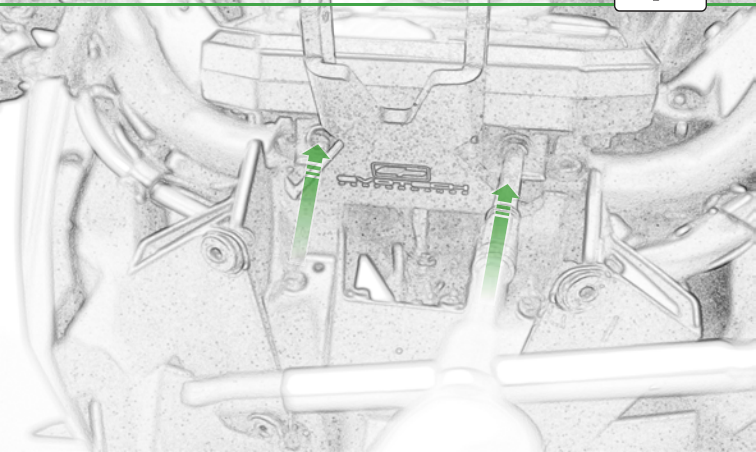

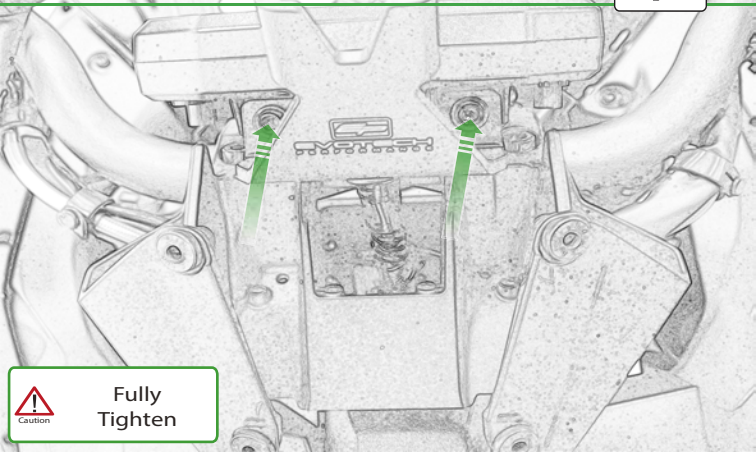

Fully
Tighten



Reverse Stages

2 - 1



SP Connect
Standard Mount



SP Connect
Anti Vibration Mount



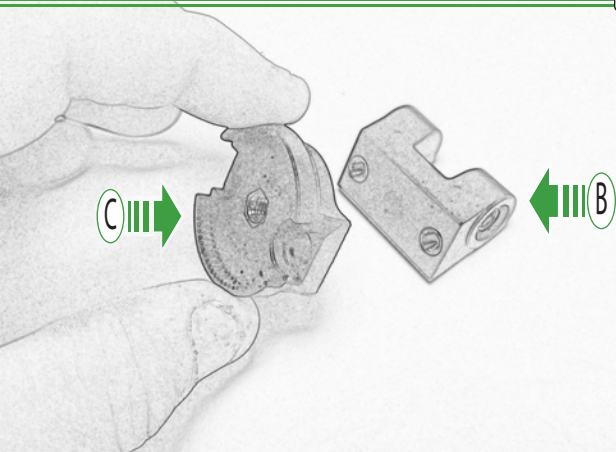

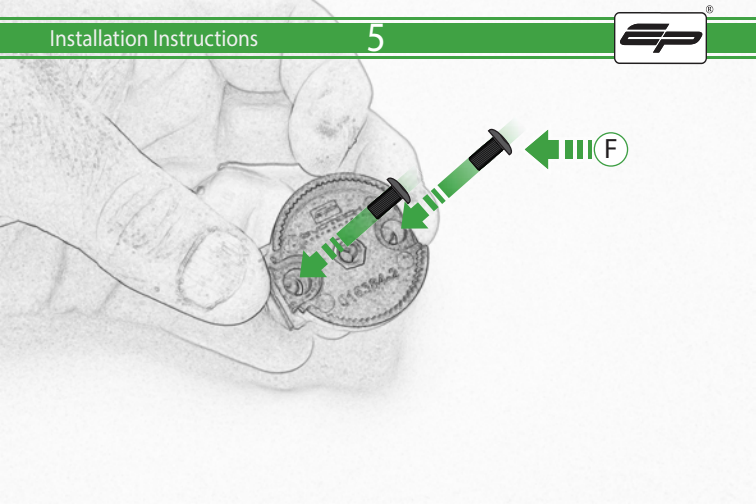

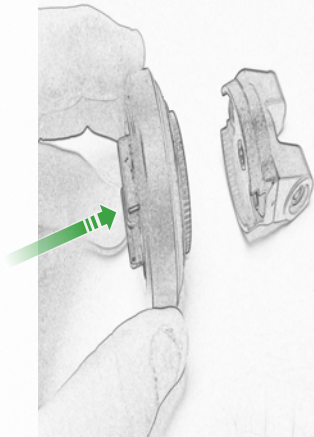
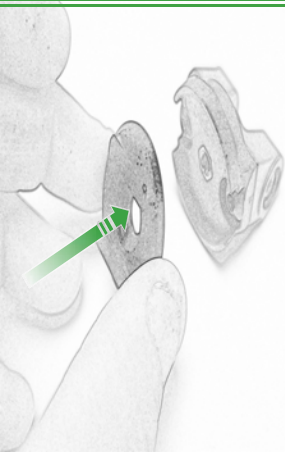

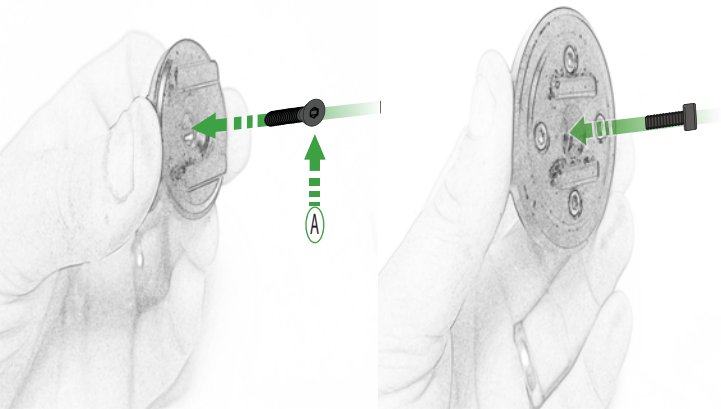

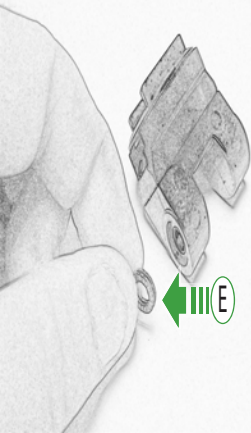



Repeat
Both Sides



Repeat
Both Sides

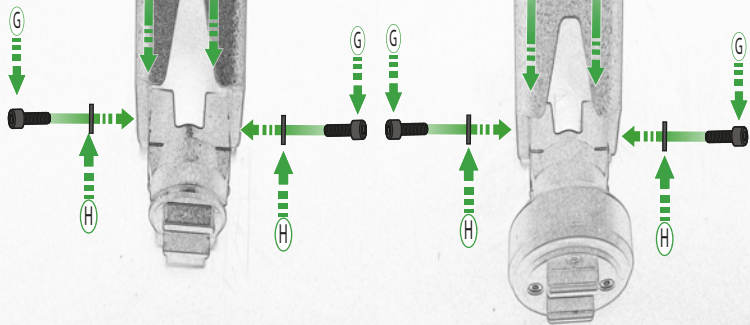

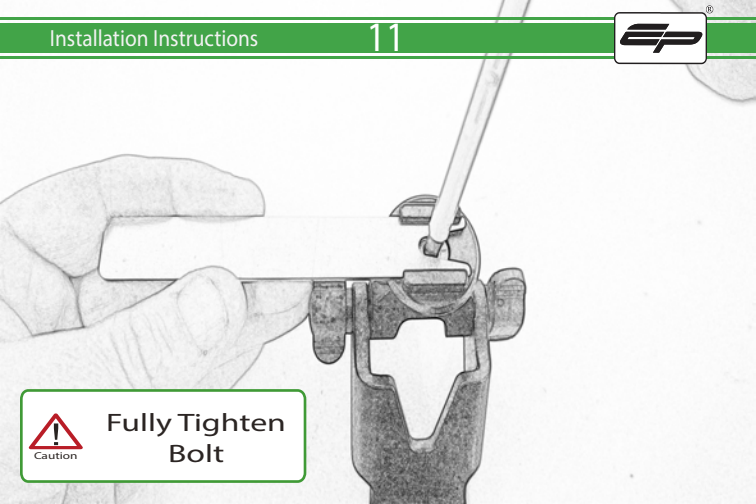

**Fully Tighten
Bolt**



ESSENTIAL CHECKS



It is recommended that periodic inspections are made to ensure that all bolts are tightened to the specified torque settings.

Should the bike be involved in an accident a thorough inspection should be made and any components that have taken an impact, no matter how small, be replaced



EVOTECH®
P E R F O R M A N C E

www.evotech-performance.com