



www.evotech-performance.com

Honda CBR500R SP Connect Satnav Mount Installation Instruction



- Ⓐ 1 x M5 x 12 Countersunk Screw
- Ⓑ 1 x Pivot Plate
- Ⓒ 1 x SP Connect Plate
- Ⓓ 1 x Spanner
- Ⓔ 2 x M5 x 6mm Black Button Head Bolt
- Ⓕ 2 x Locking Washer
- Ⓖ 2 x M5 Black Washer
- Ⓗ 2 x M5 x 10mm Black Button Head Bolt
- Ⓘ 2 x M5 x 12mm Caphead Bolts

EVOTECH[®]
P E R F O R M A N C E

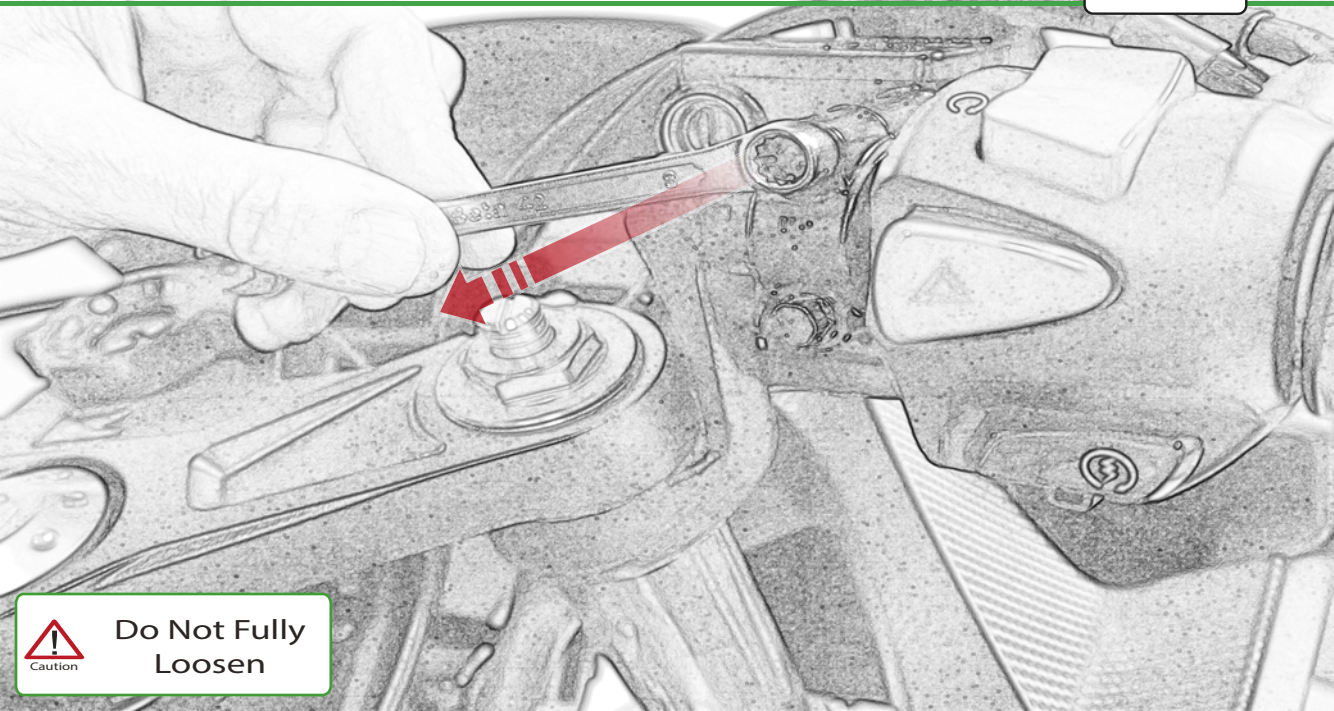

Caution

**Do Not Fully
Loosen**

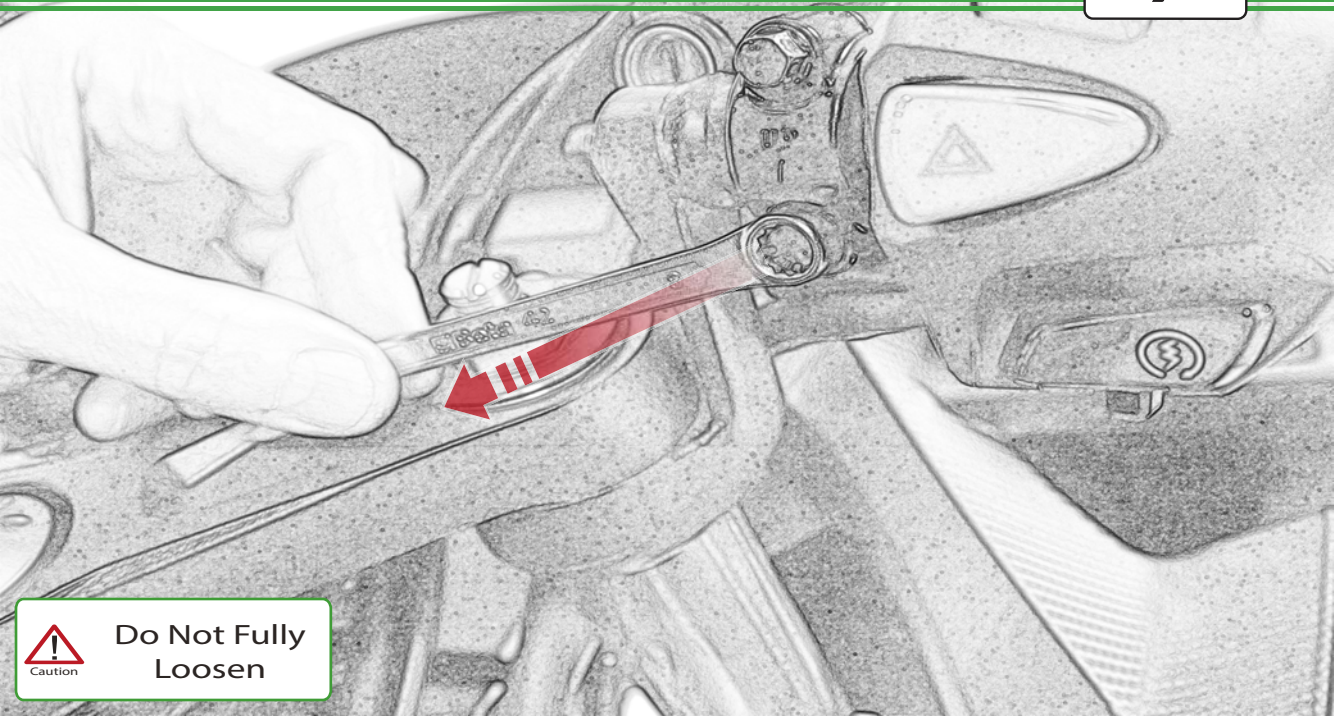

Caution

**Do Not Fully
Loosen**

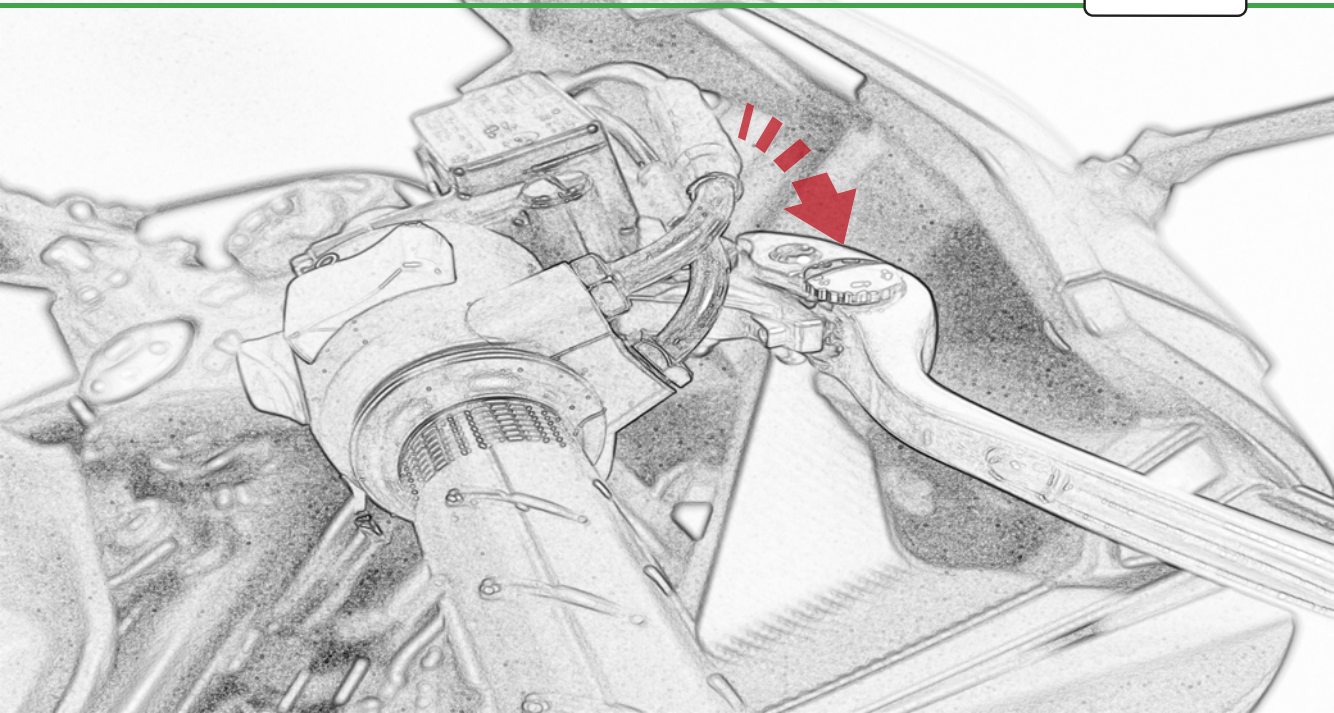

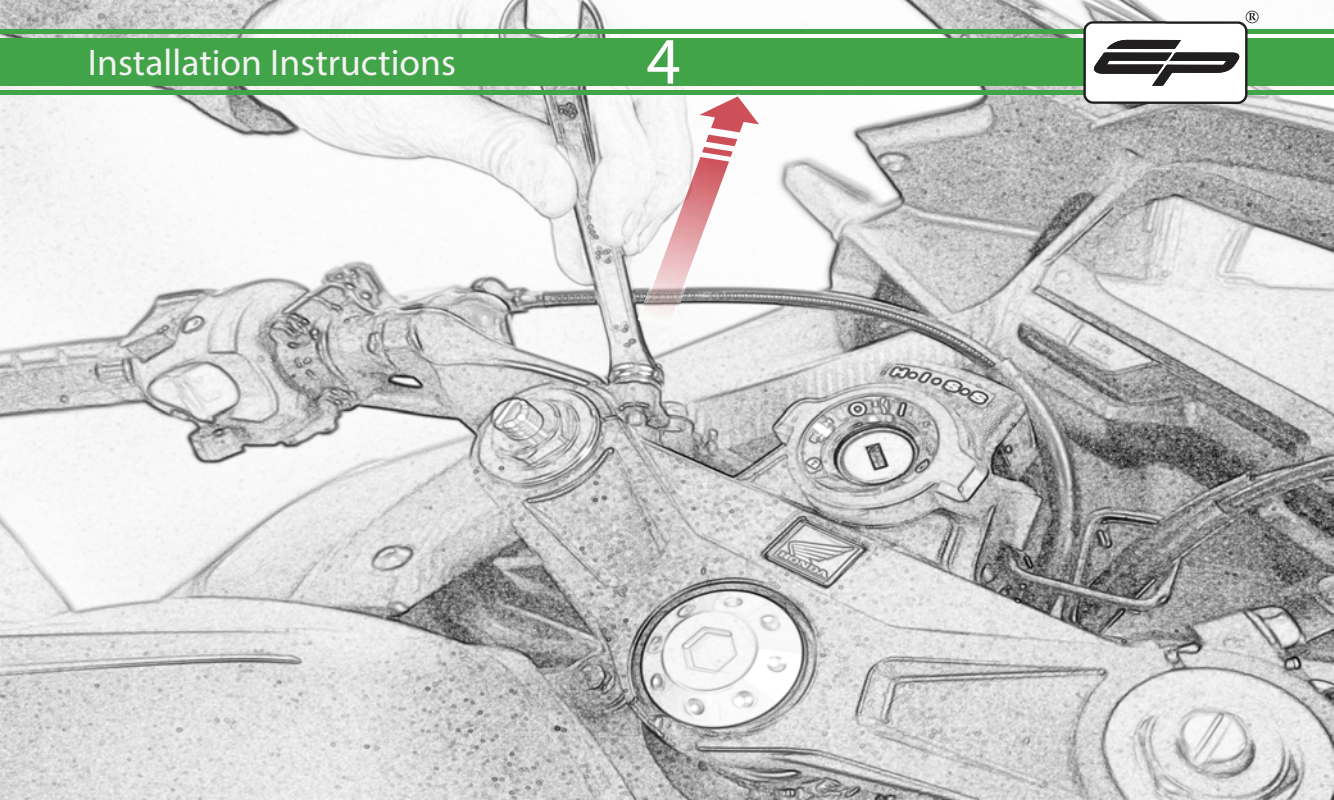

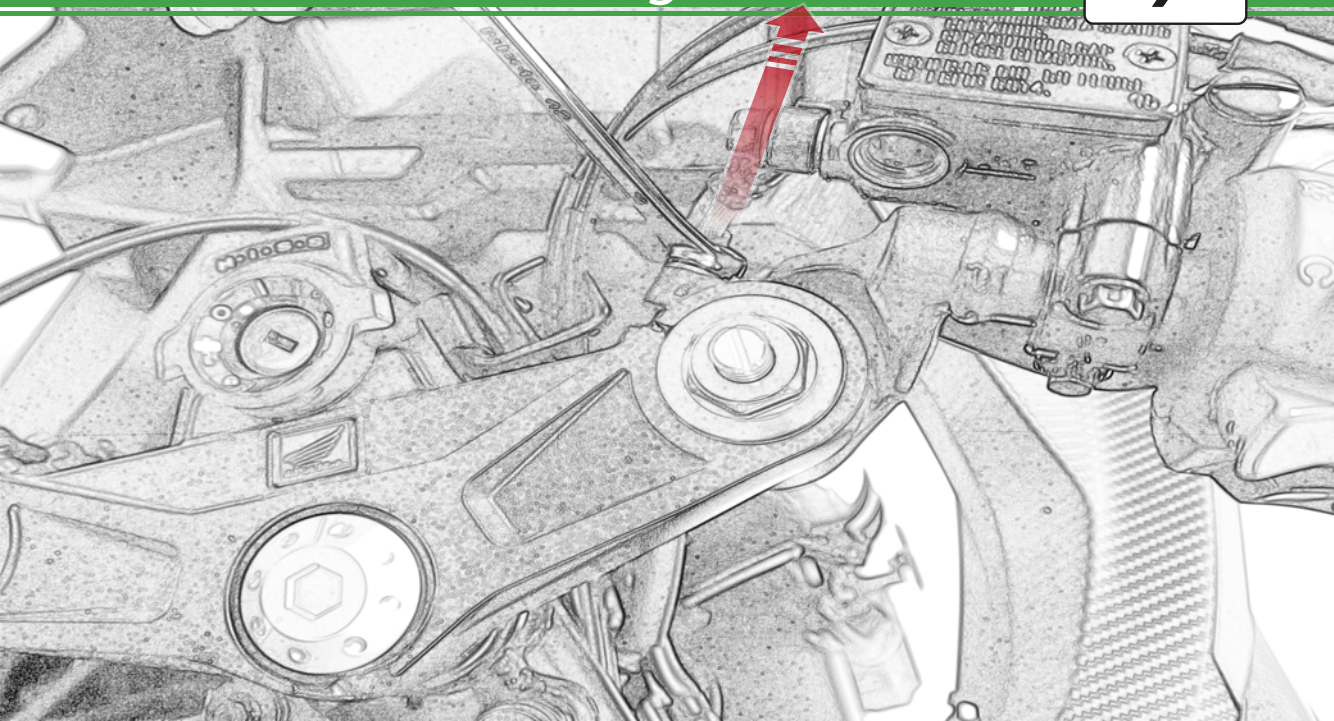

Installation Instructions



5

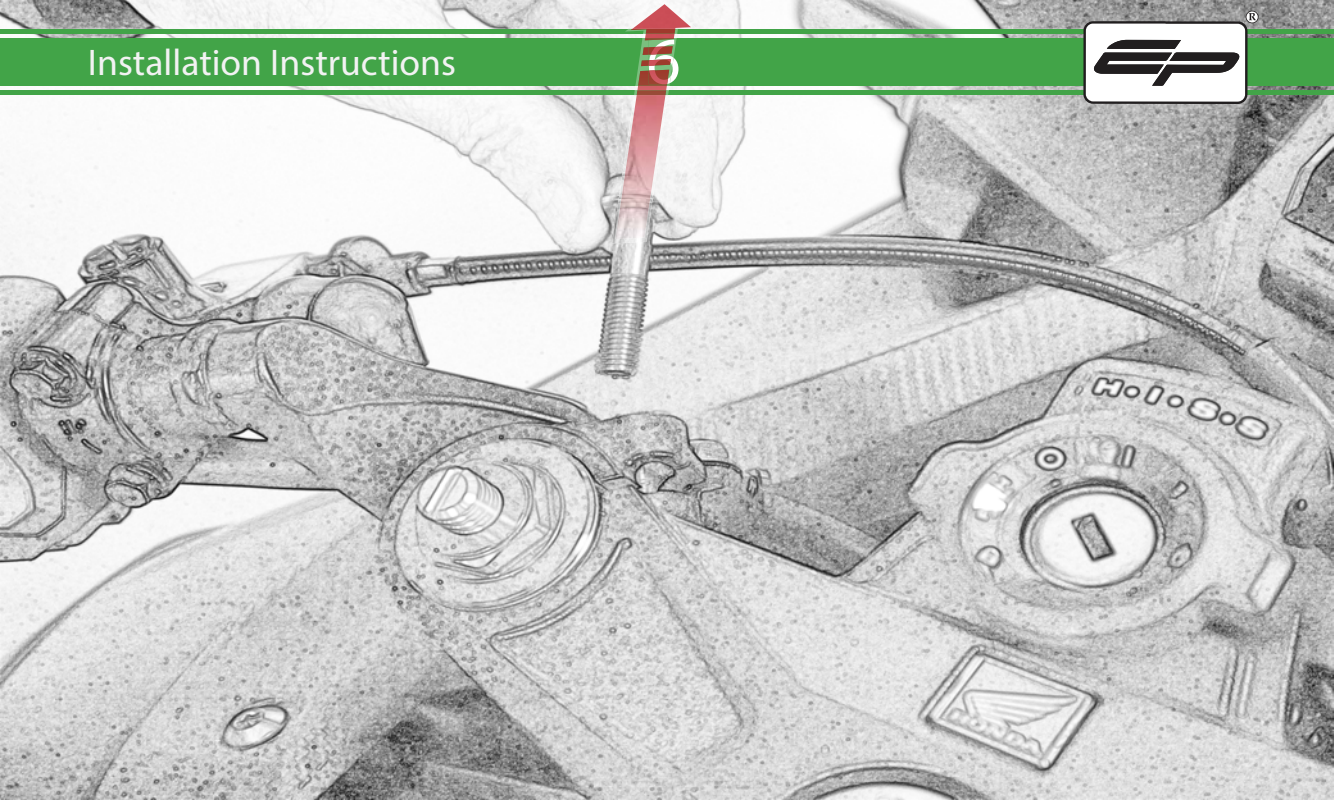

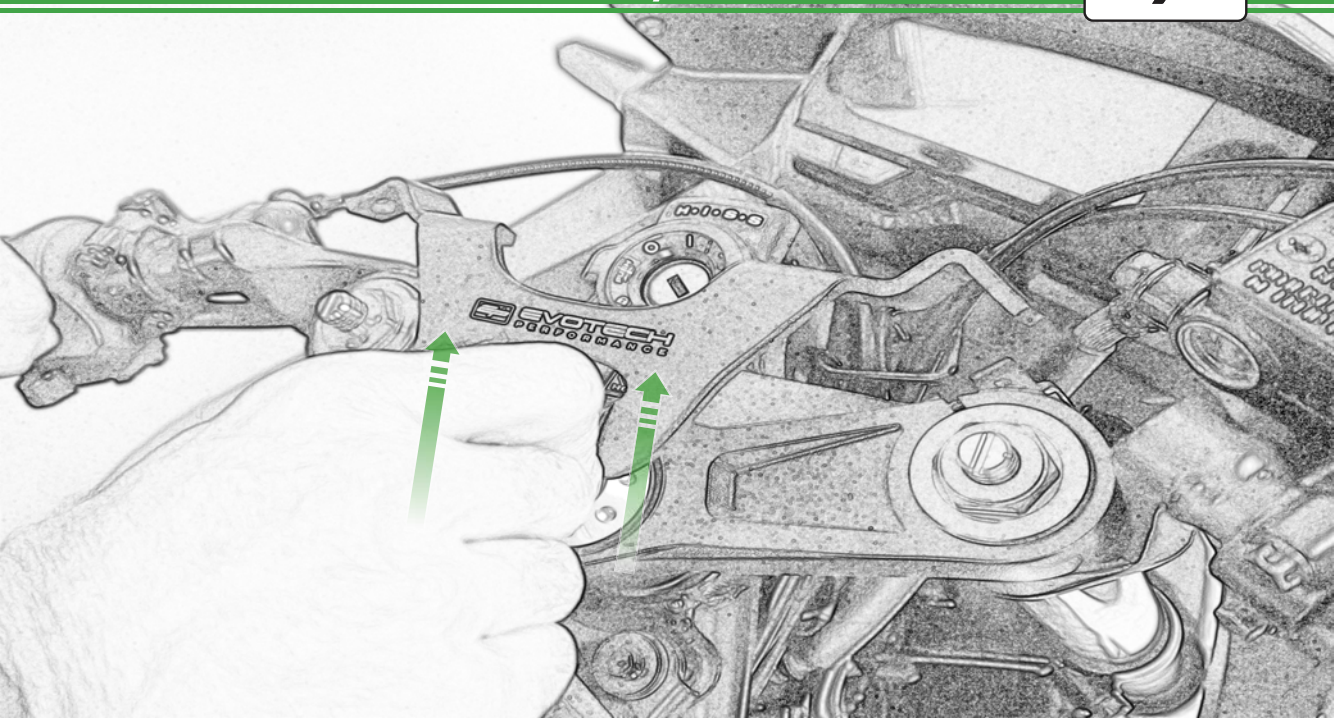

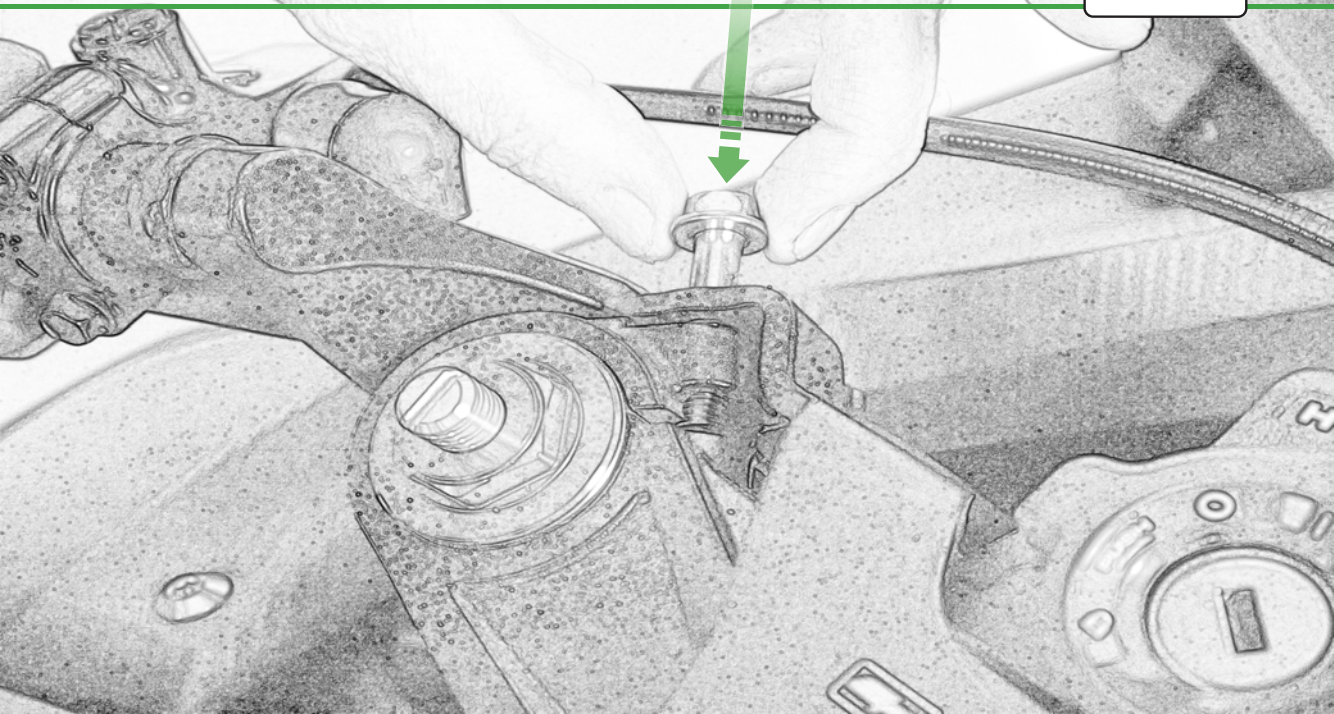

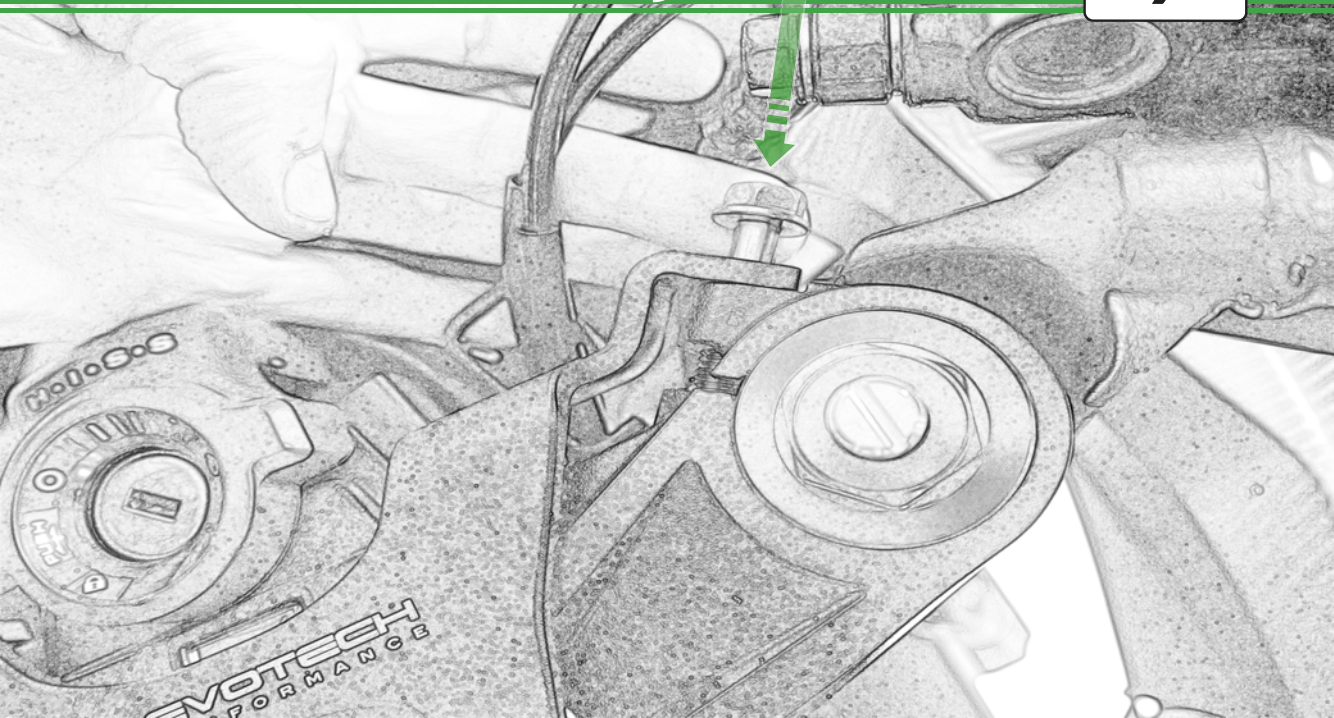

EVOTECH
PERFORMANCE

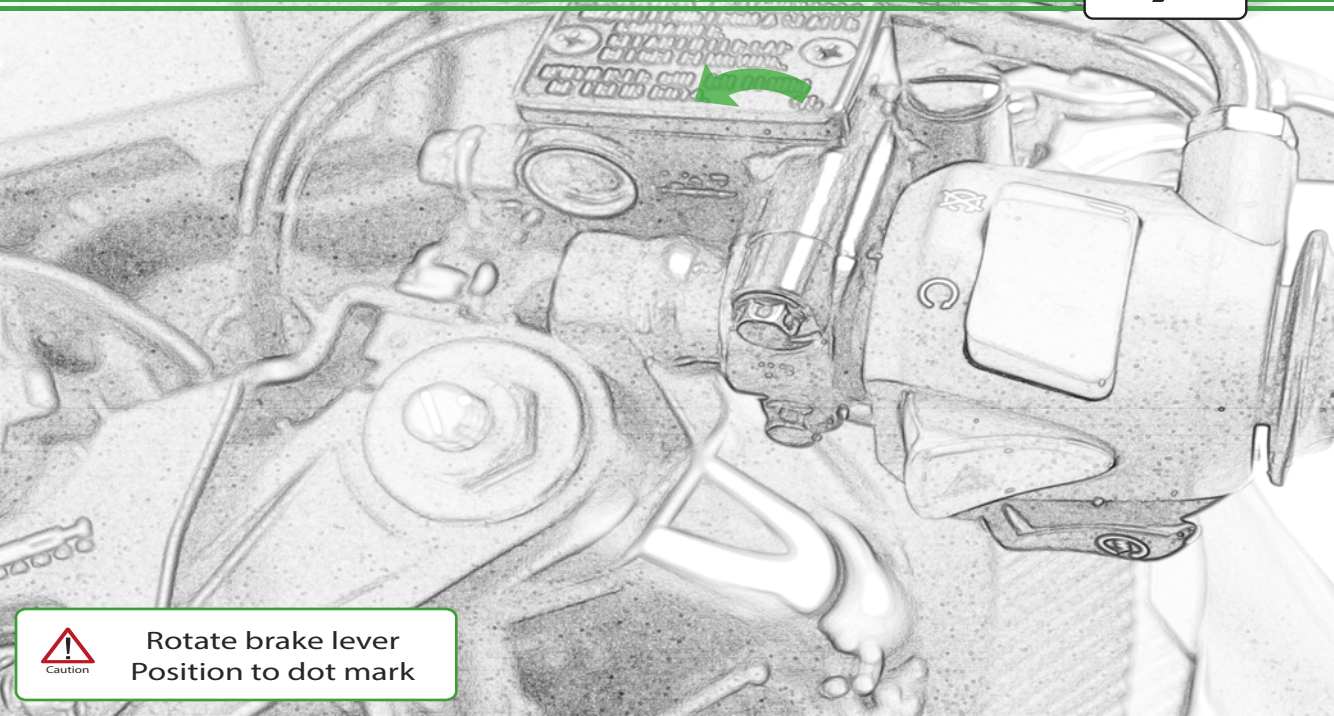

Caution

Rotate brake lever
Position to dot mark





SP Connect
Standard Mount



SP Connect
Anti Vibration Mount



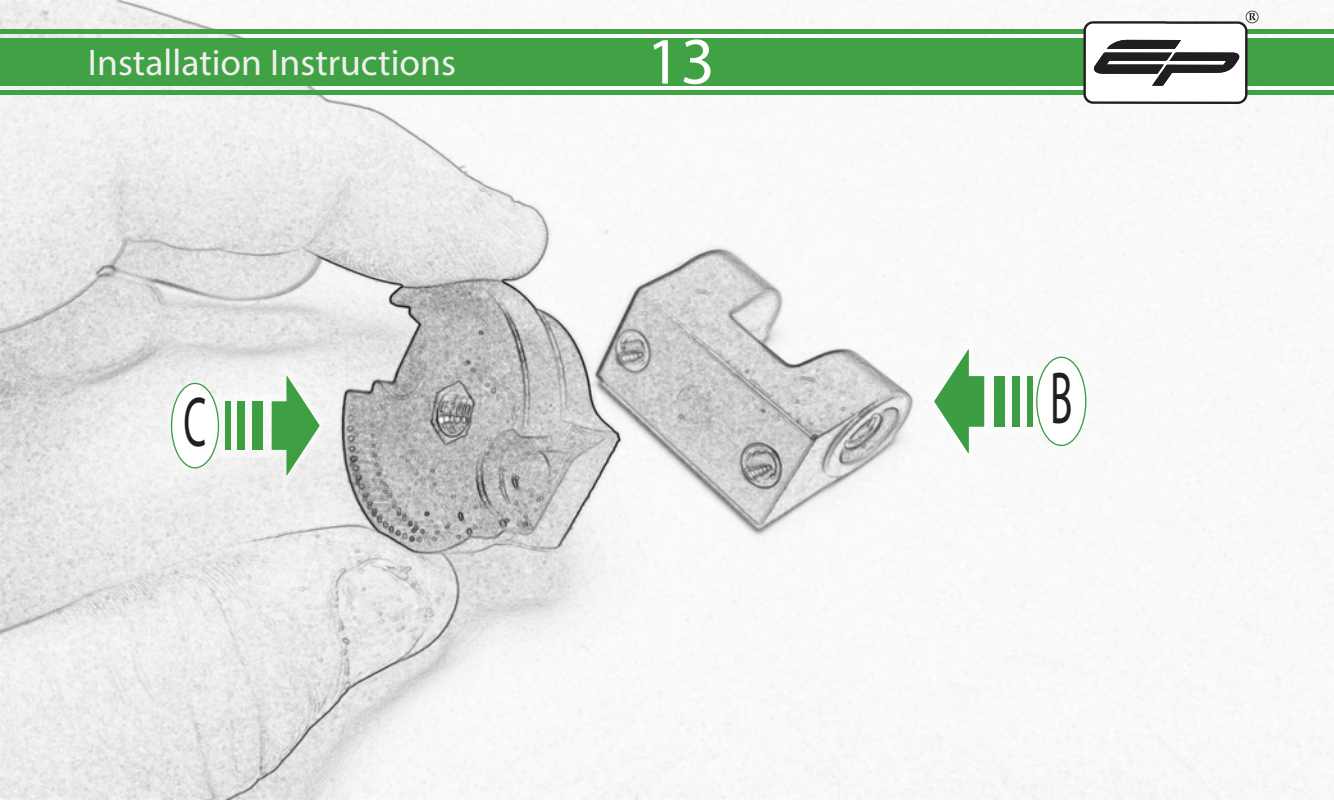



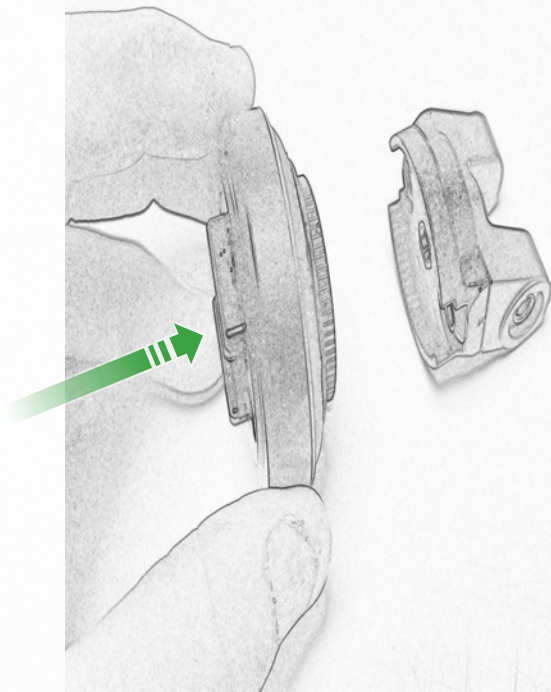
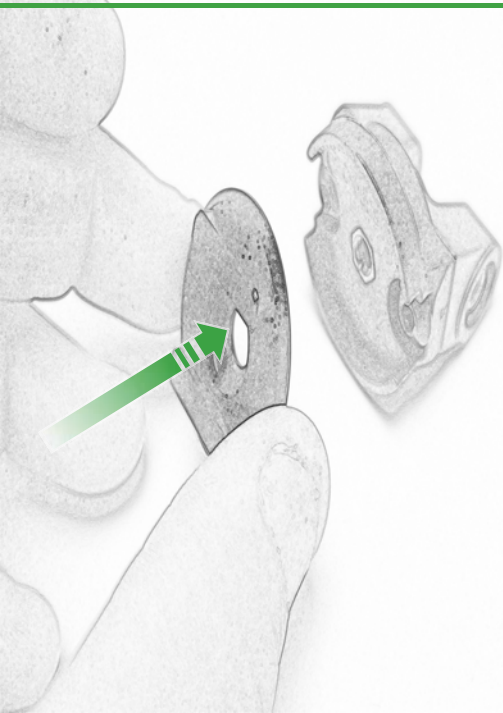

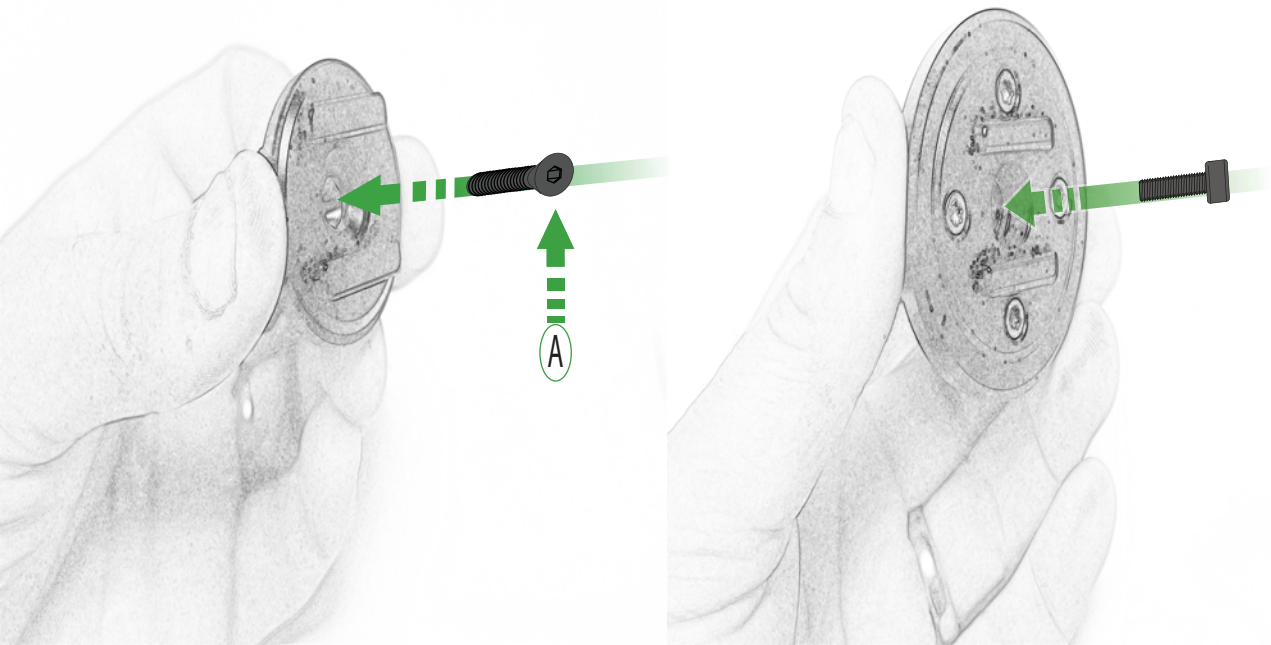

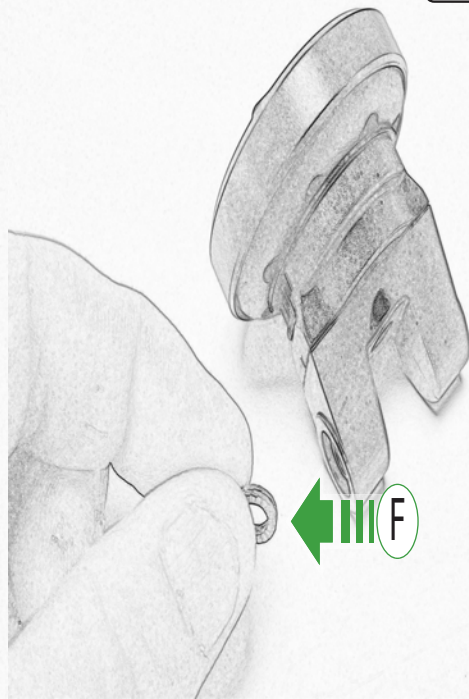
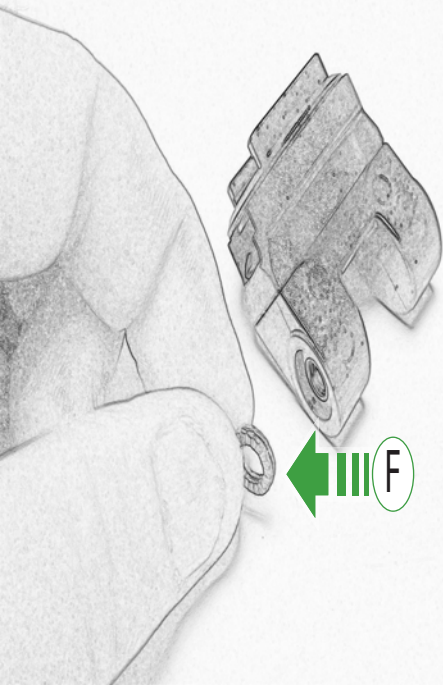

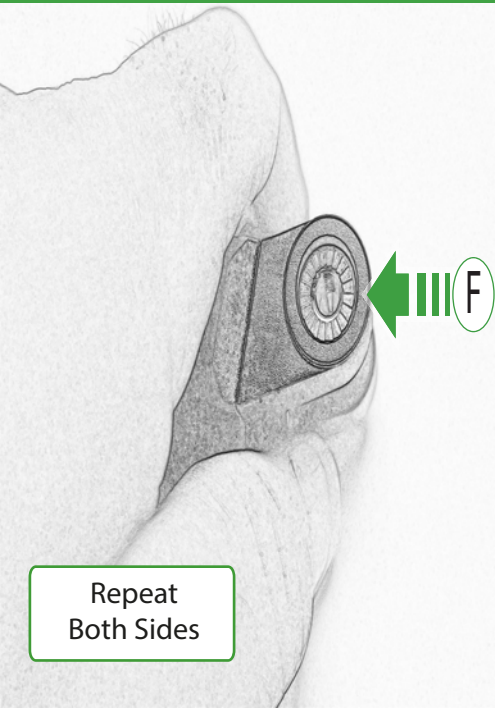

Repeat
Both Sides

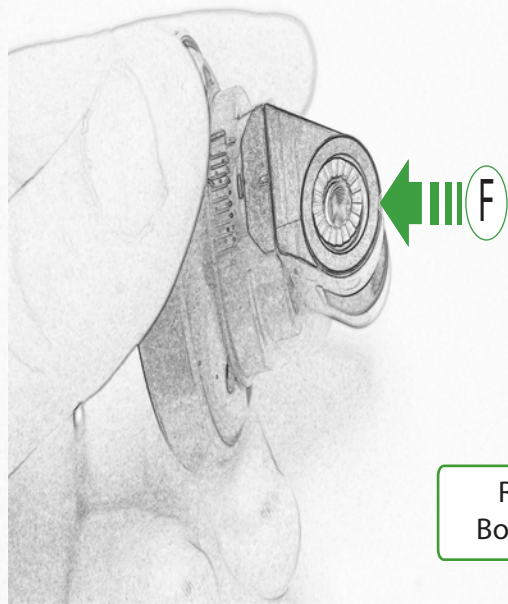

Repeat
Both Sides

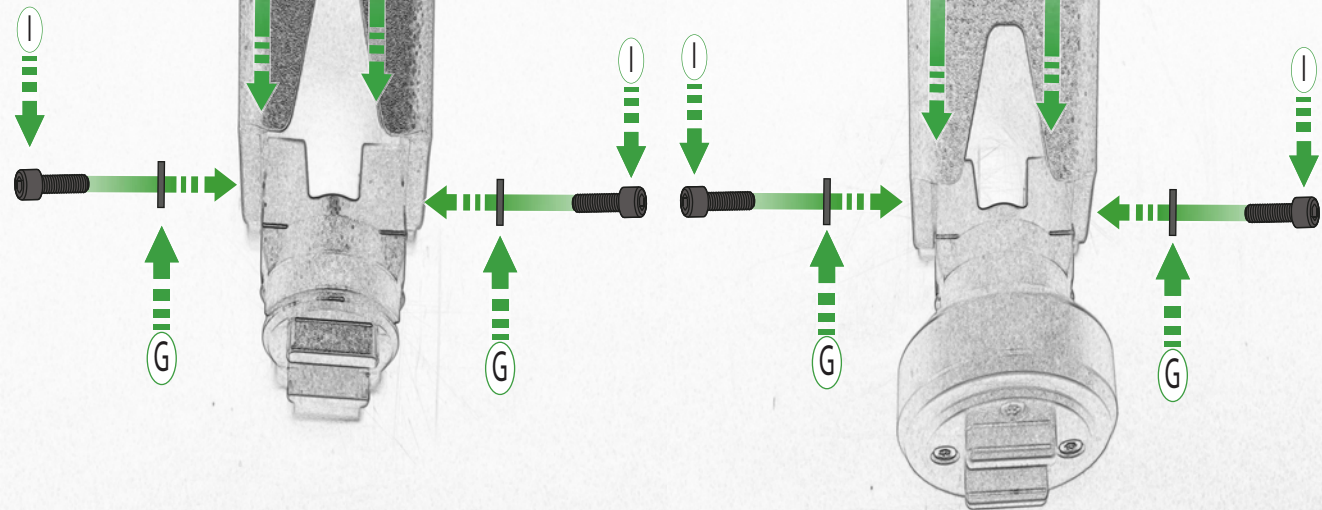

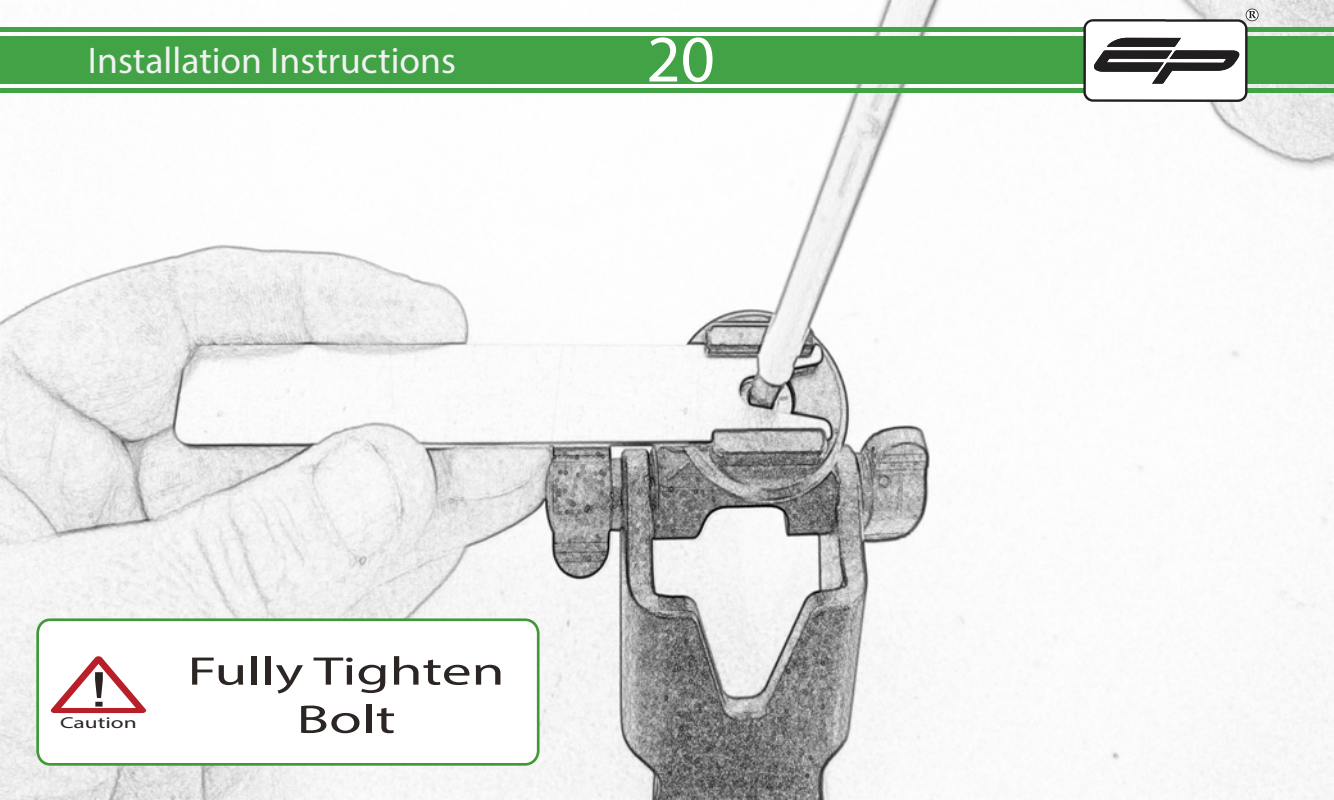

Caution

**Fully Tighten
Bolt**



ESSENTIAL CHECKS



It is recommended that periodic inspections are made to ensure that all bolts are tightend to the specified torque settings.

Should the bike be involved in an accident a thorough inspection should be made and any components that have taken an impact, no matter how small, be replaced

P E R F O R M A N C E



EVOTECH®
P E R F O R M A N C E

www.evotech-performance.com