



EVOTECH®
P E R F O R M A N C E

www.evotech-performance.com

MV Agusta Brutale 800 Connect Satnav Mount Installation Instruction



- (A) 1 x M5 x 12 Countersunk Screw
- (B) 1 x Pivot Plate
- (C) 1 x SP Connect Plate
- (D) 1 x Spanner
- (E) 2 x M5 x 12mm Caphead Bolts
- (F) 2 x Locking Washer
- (G) 2 x M5 Black Washer
- (H) 2 x M5 x 10mm Black Button Head Bolt
- (I) 2 x M5 x 6mm Black Button Head Bolt
- (AA) 1 x Rubber Pad
- (BB) 2 x M5 x 45mm Black Button Head Bolts
- (CC) 2 x M5 x 25mm Black Button Head Bolts
- (DD) 4 x Spacers

EVOTECH[®]
P E R F O R M A N C E

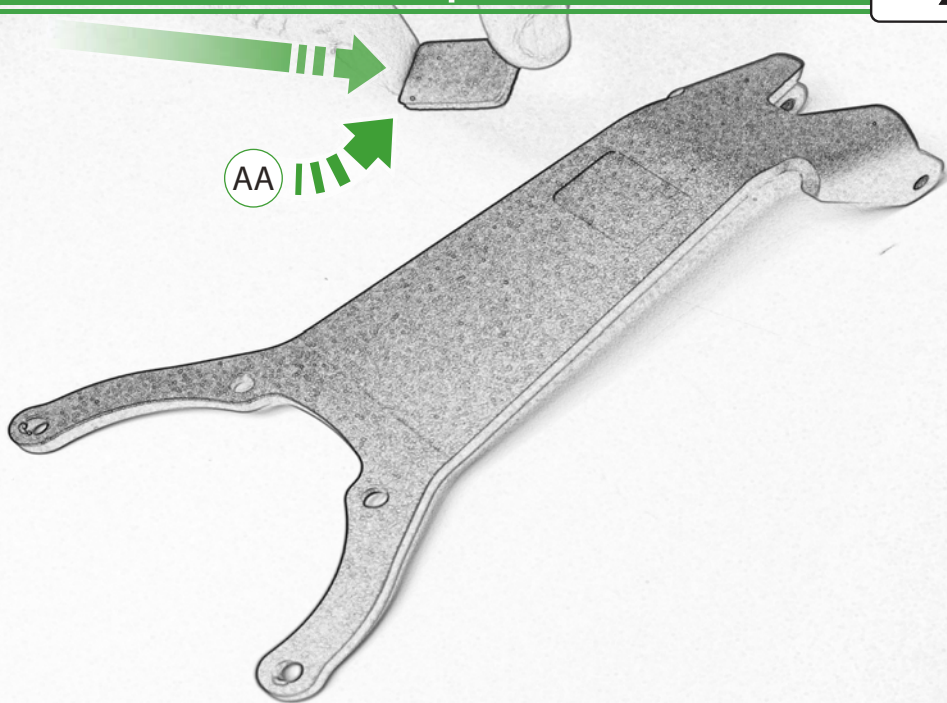

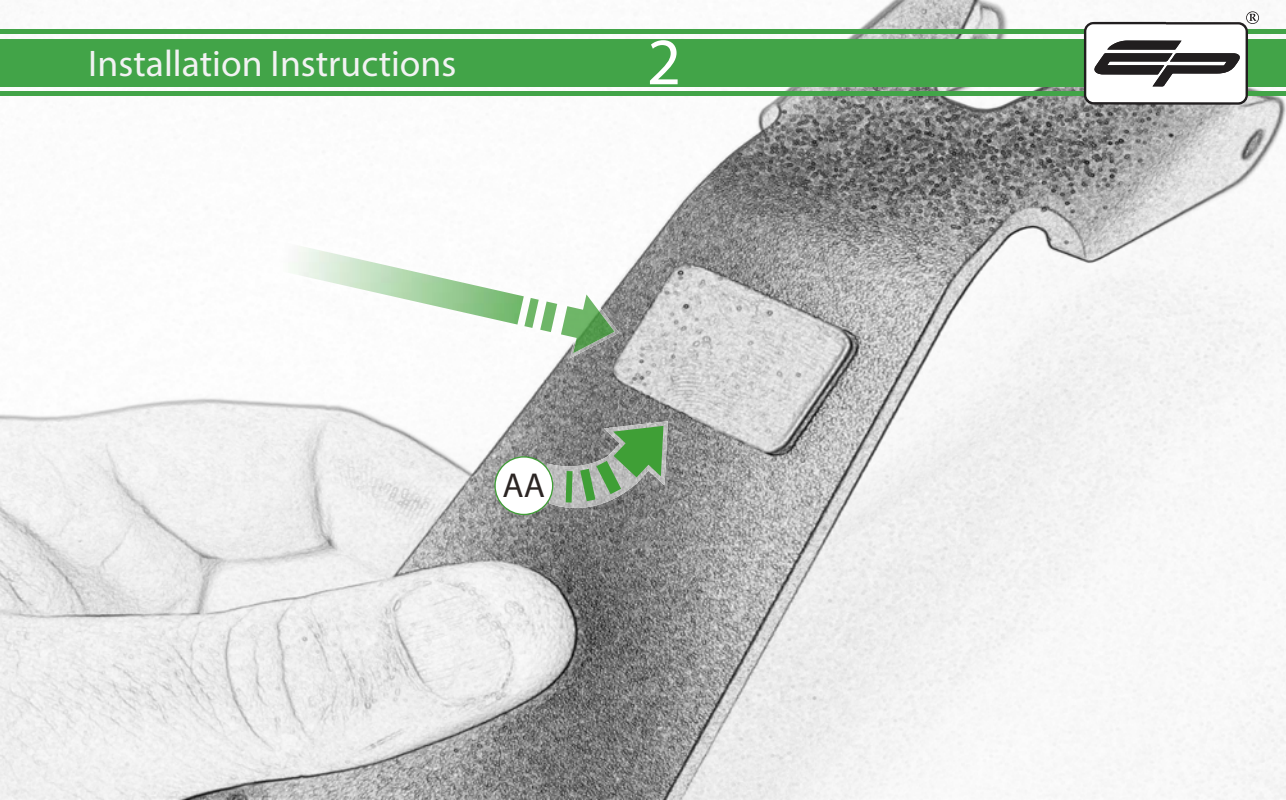

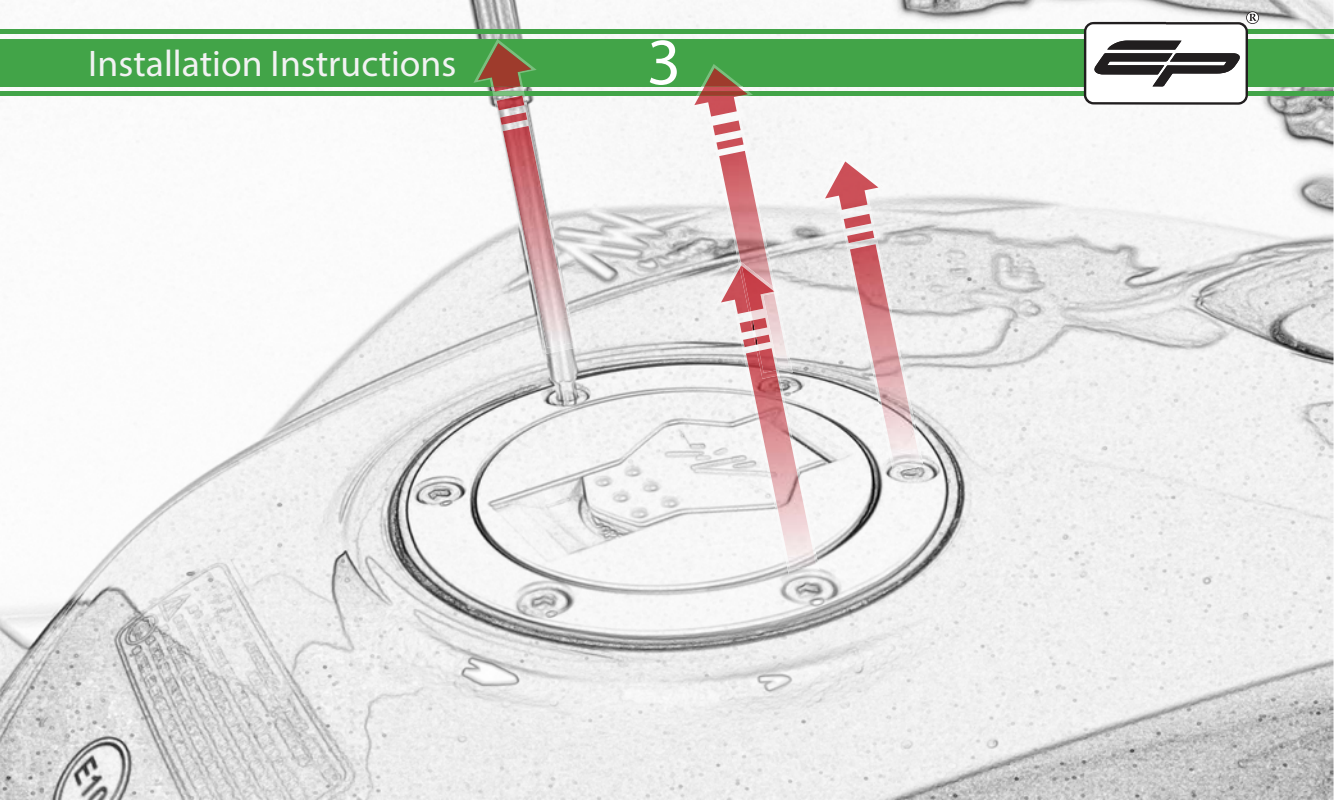

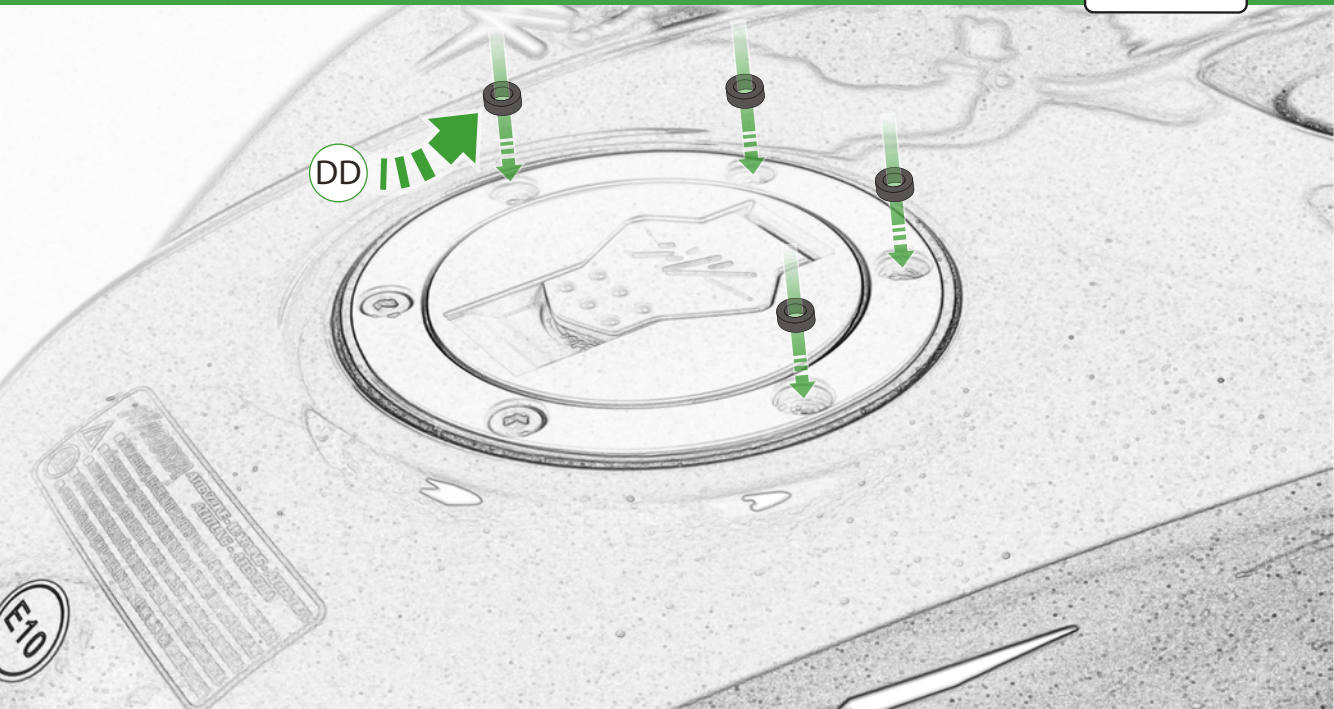

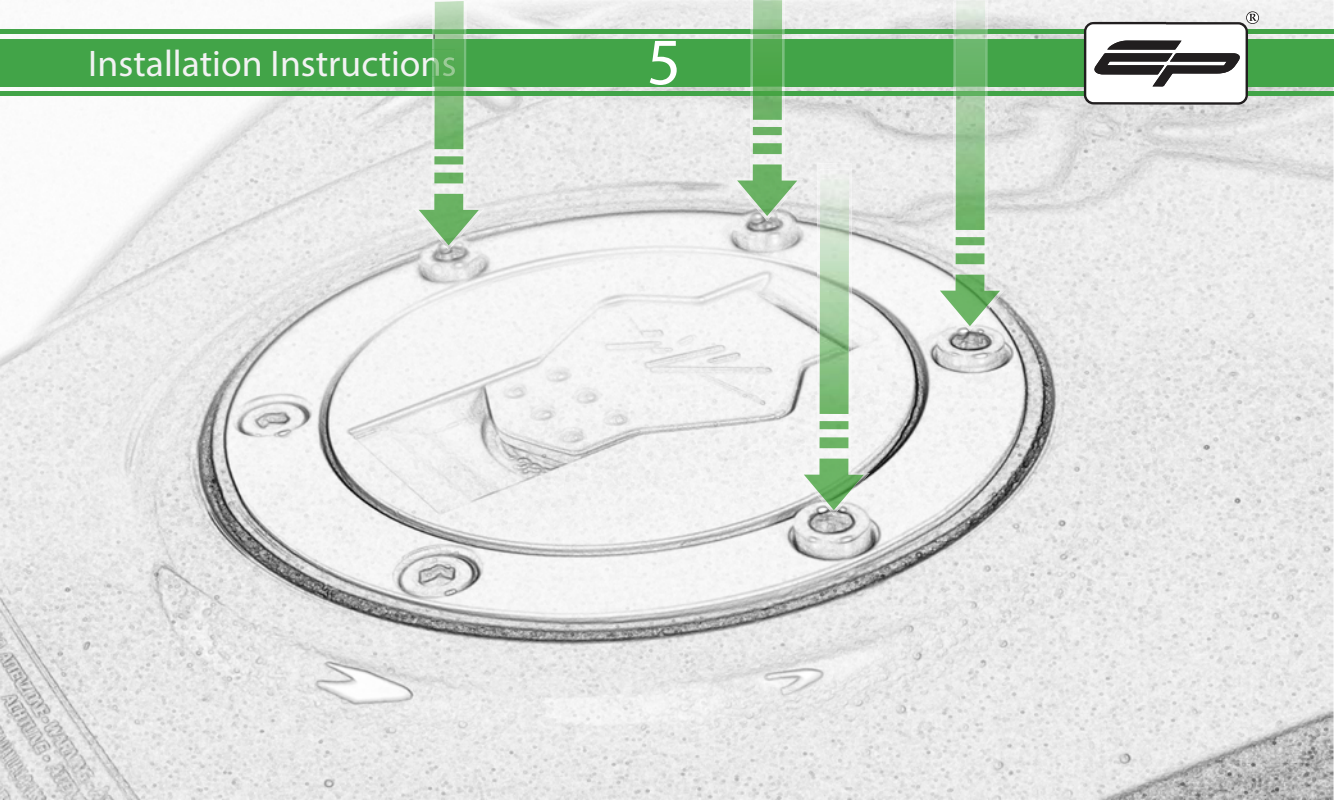

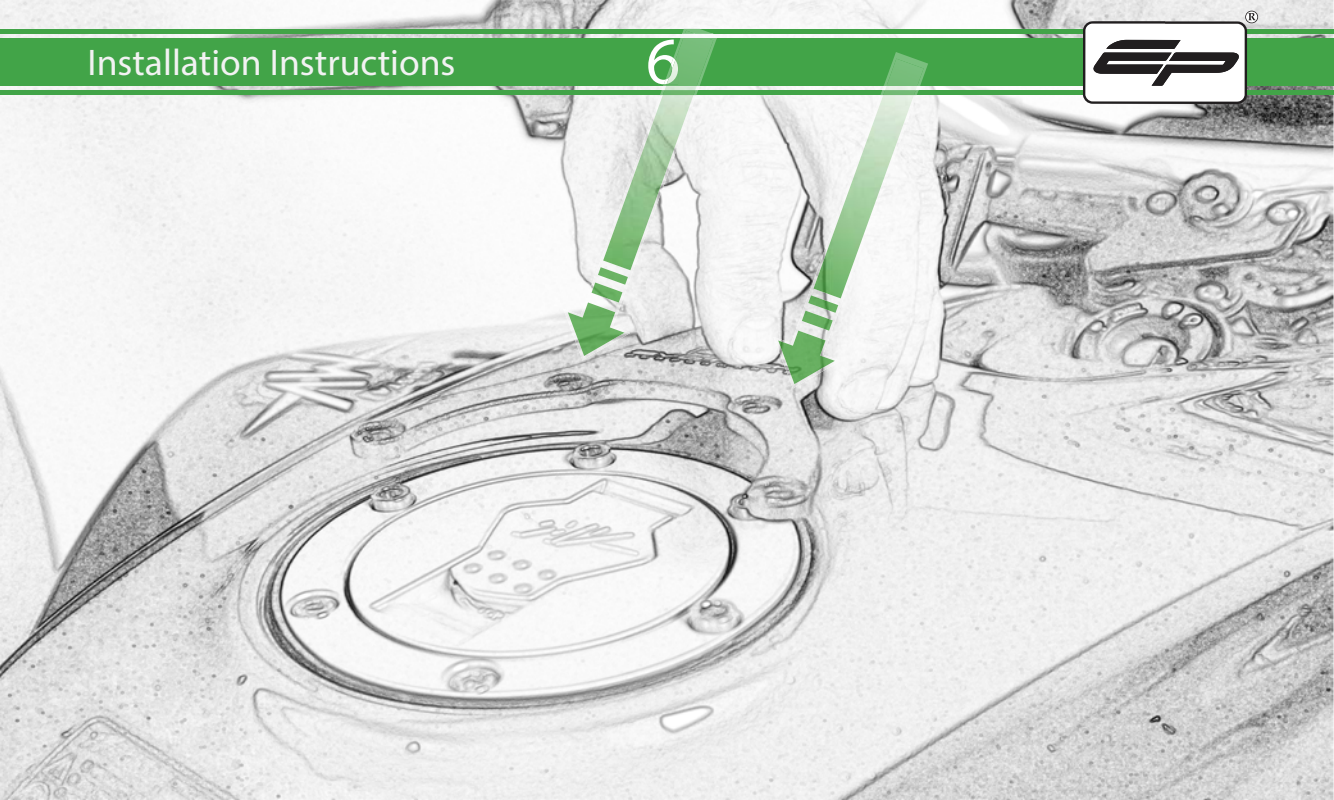

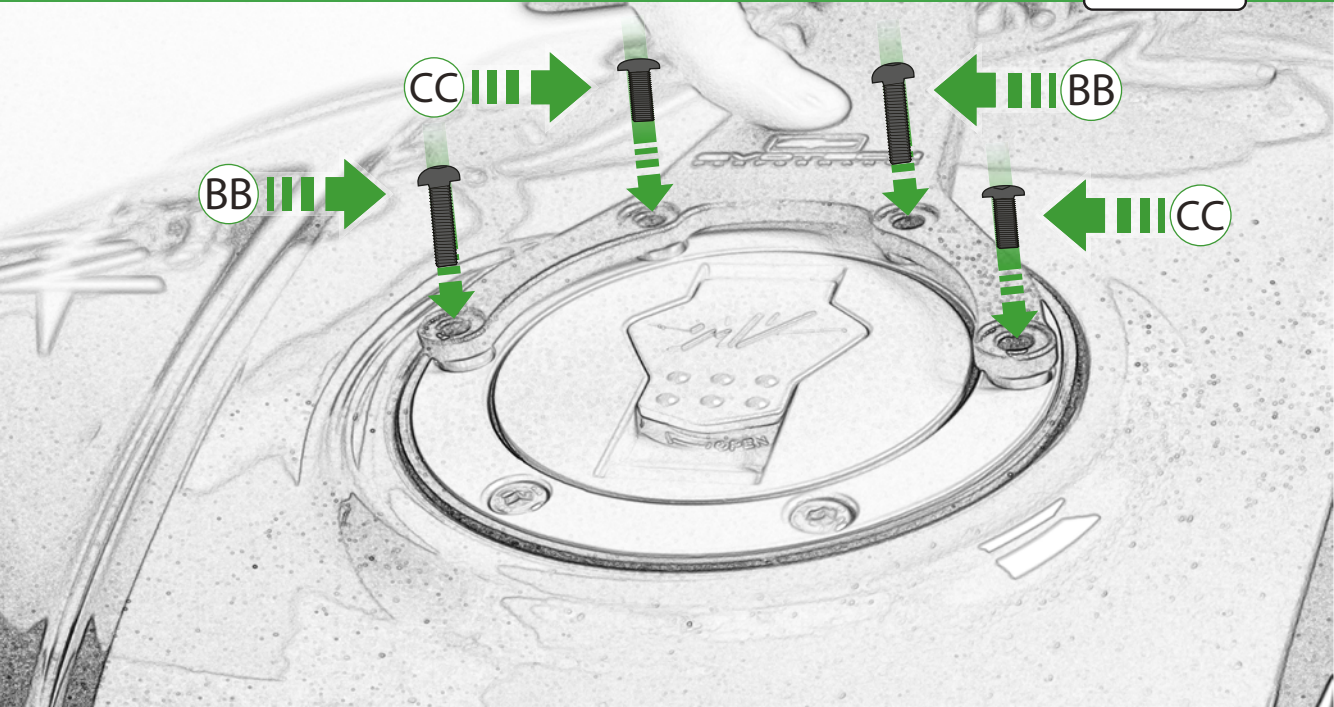

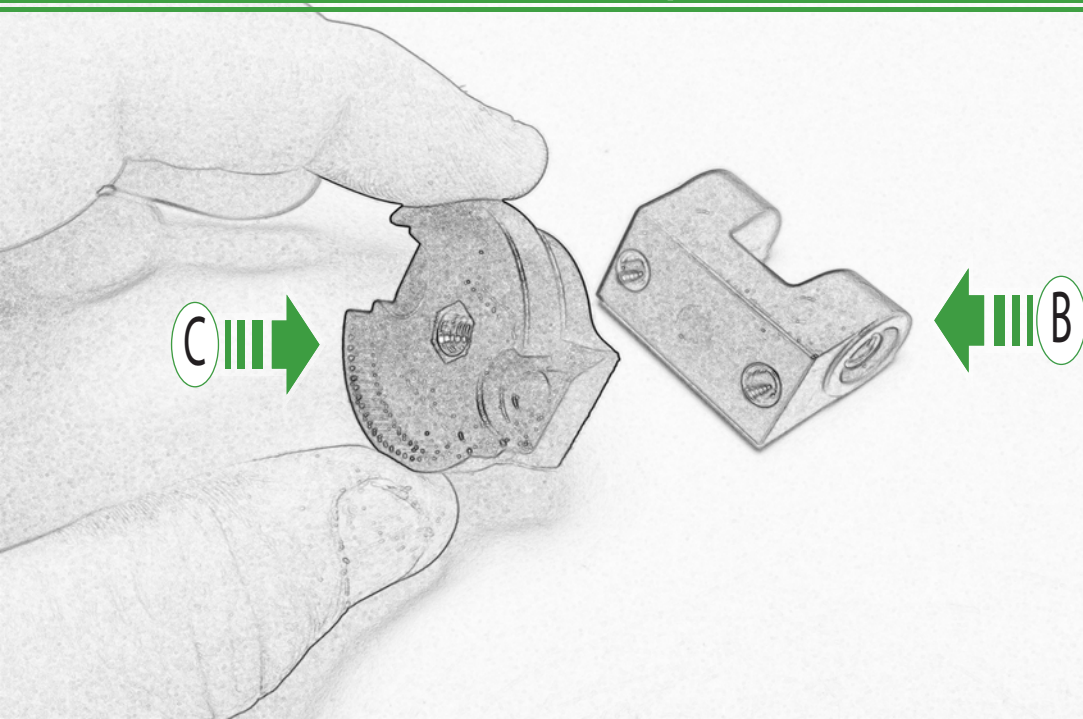



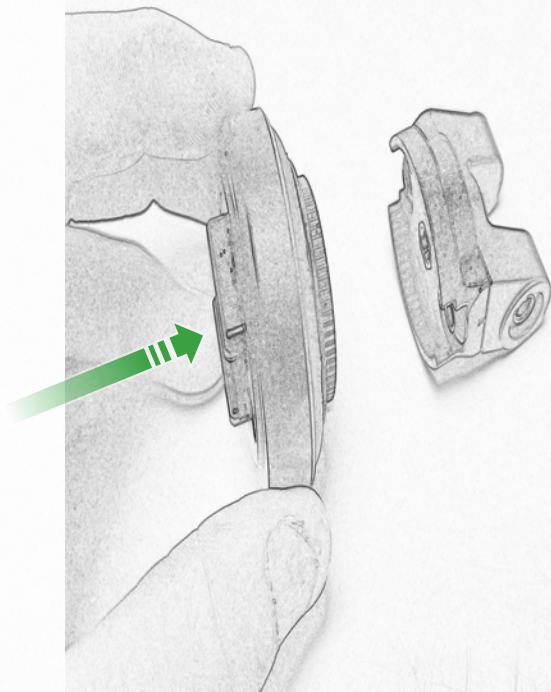
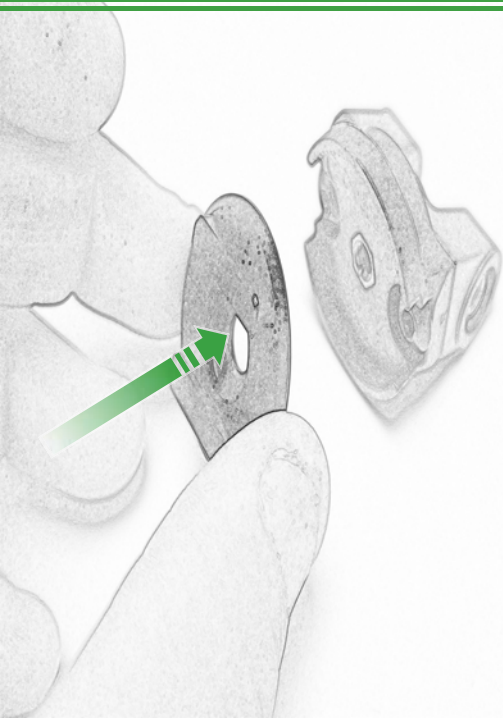

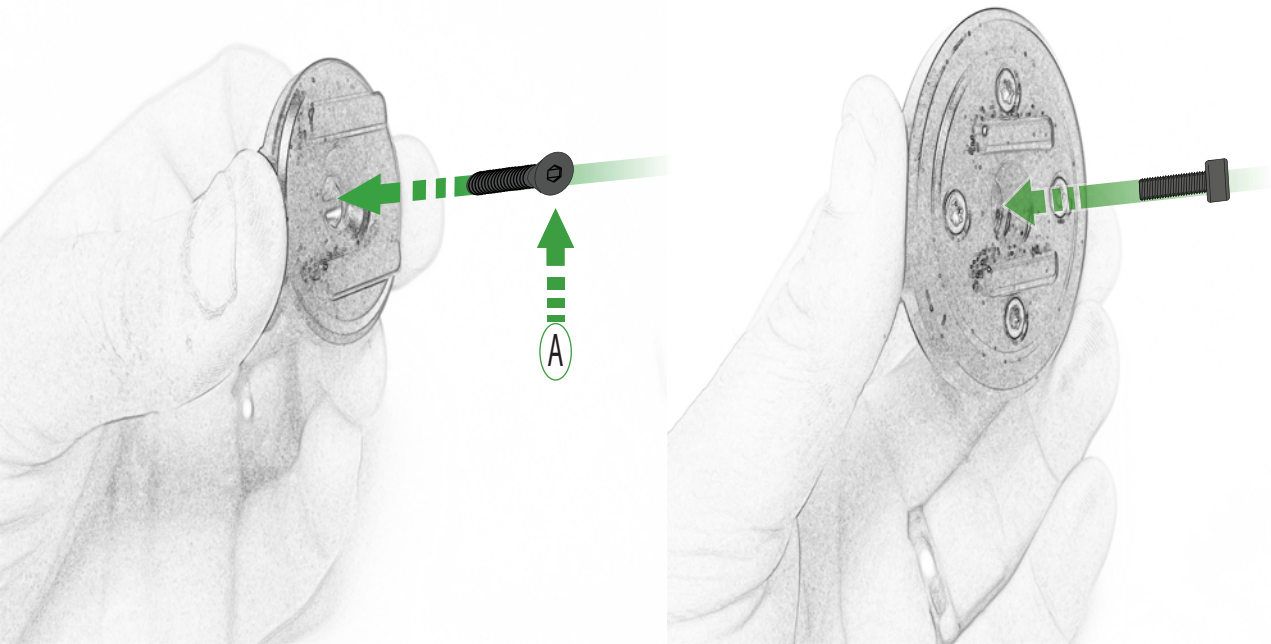

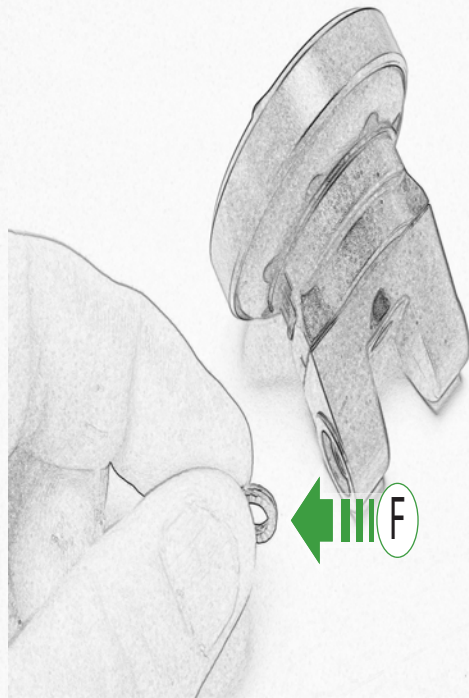
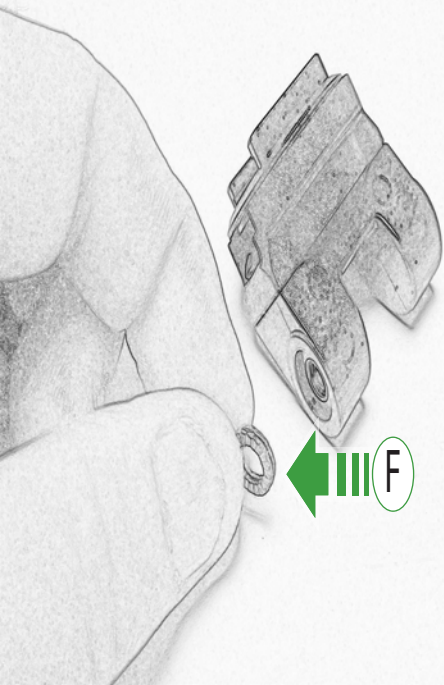



Repeat
Both Sides

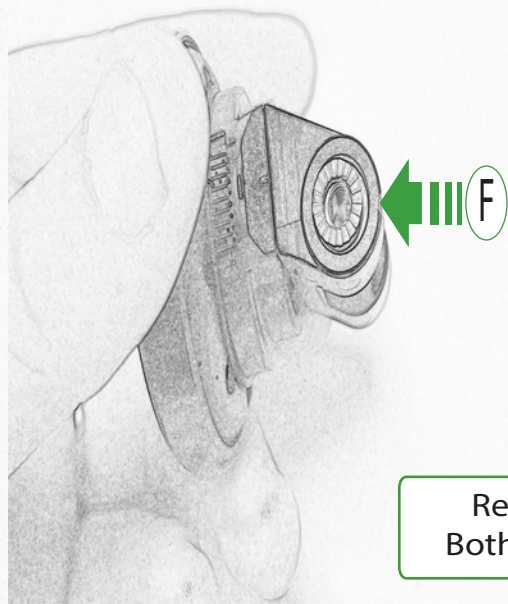

Repeat
Both Sides

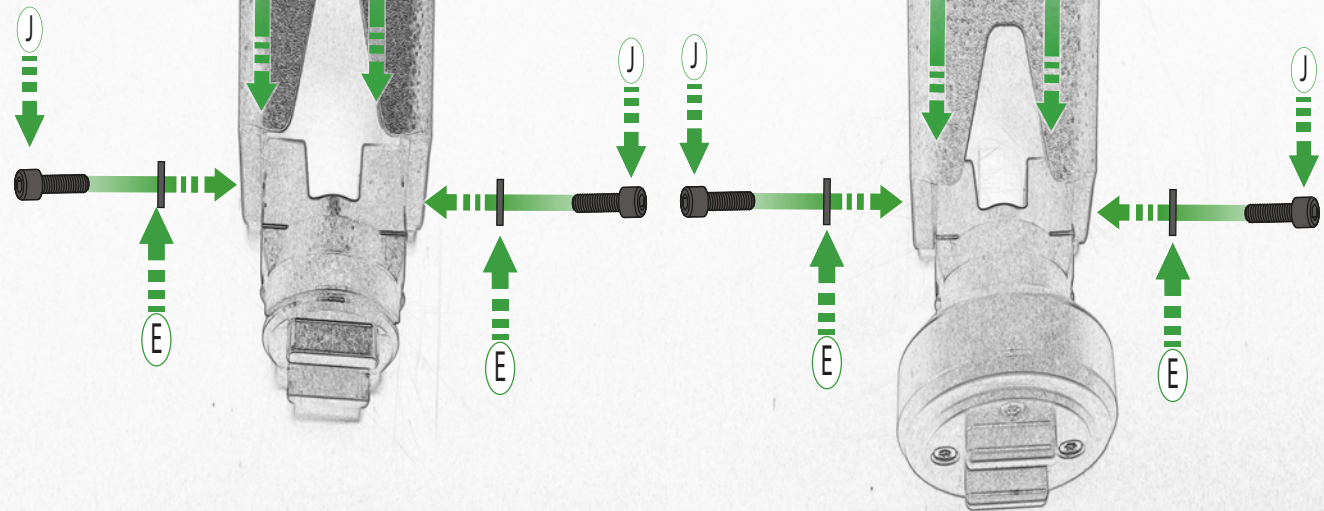

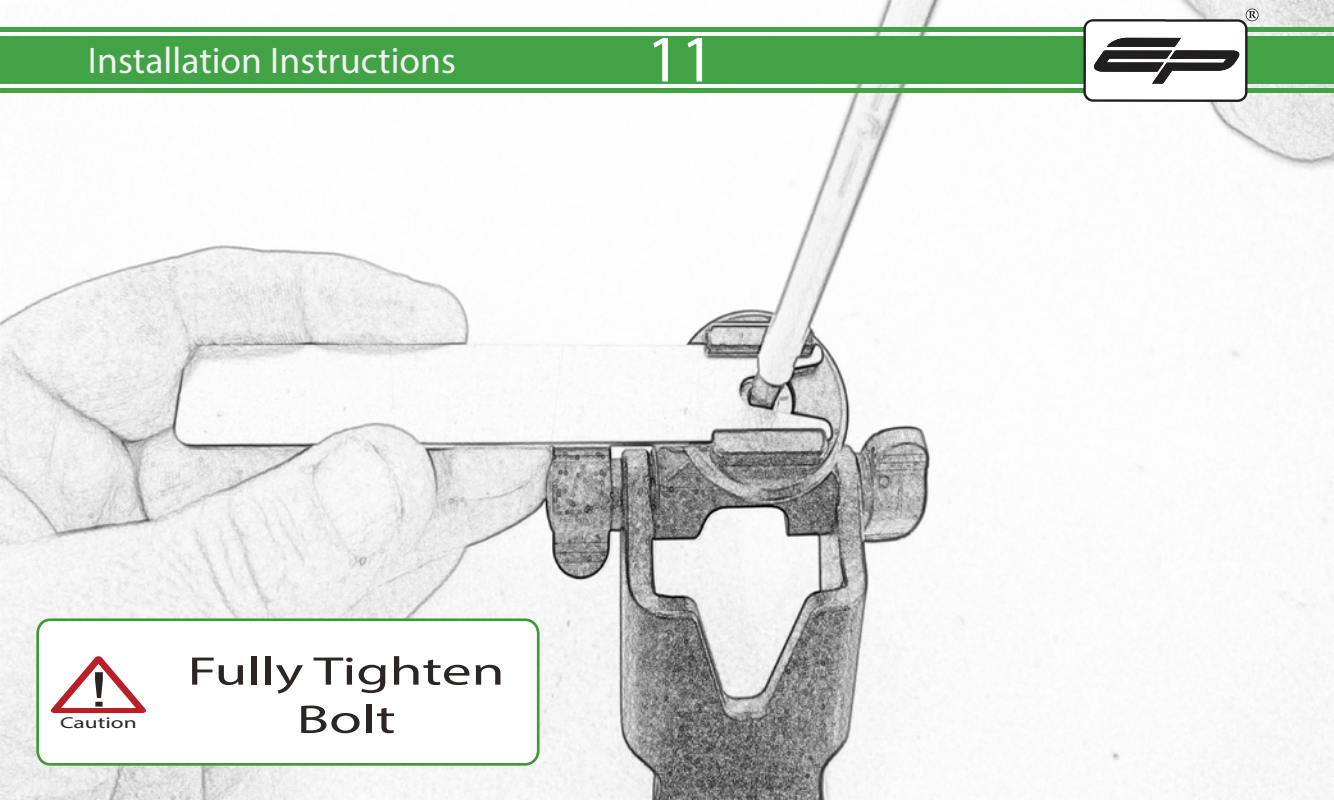

**Fully Tighten
Bolt**



ESSENTIAL CHECKS



It is recommended that periodic inspections are made to ensure that all bolts are tightened to the specified torque settings.

Should the bike be involved in an accident a thorough inspection should be made and any components that have taken an impact, no matter how small, be replaced



EVOTECH®
P E R F O R M A N C E

www.evotech-performance.com