

EVOTECH®
P E R F O R M A N C E

www.evotech-performance.com

KTM 1290 Super Duke

Action Camera / Beeline Mount Instructions

Kit Contents

- Ⓐ 1 x Pivot Plate
- Ⓑ 1 x Main Bracket
- Ⓒ 1 x Camera Mount
- Ⓓ 1 x Rubber Pad
- Ⓔ 1 x M5 Washers
- Ⓕ 1 x M5 x 20mm Caphead
- Ⓖ 2 x M5 x 8mm Caphead
- Ⓗ 2 x M5 x 10mm Caphead
- Ⓘ 2 x Nord Lock Washers
- Ⓙ 4 x M5 x 40mm Black Button Head Bolts
- Ⓚ 4 x Spacers

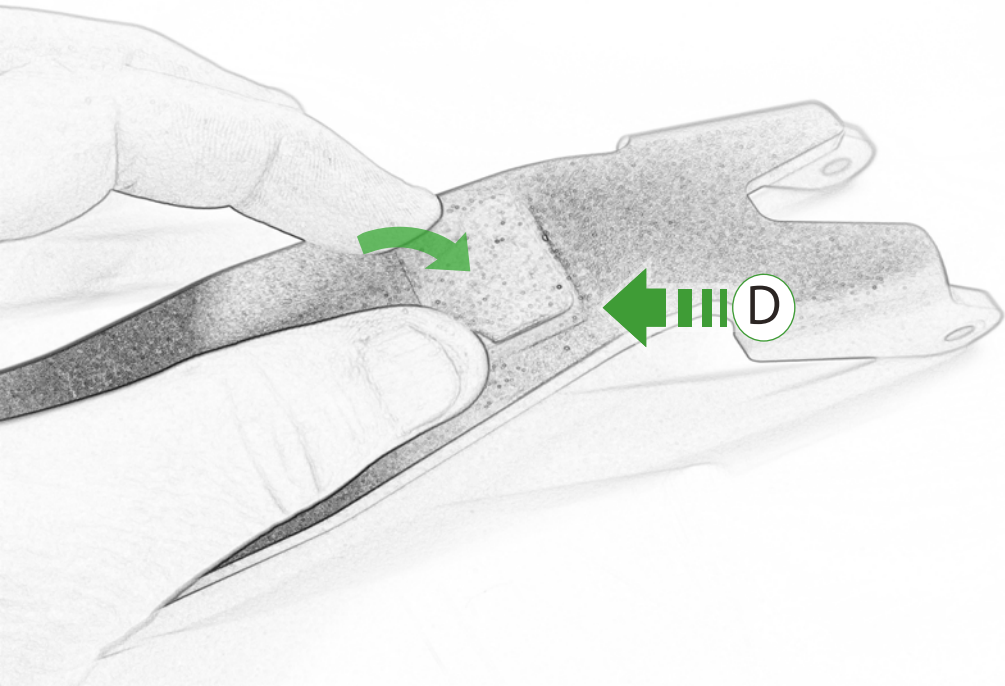

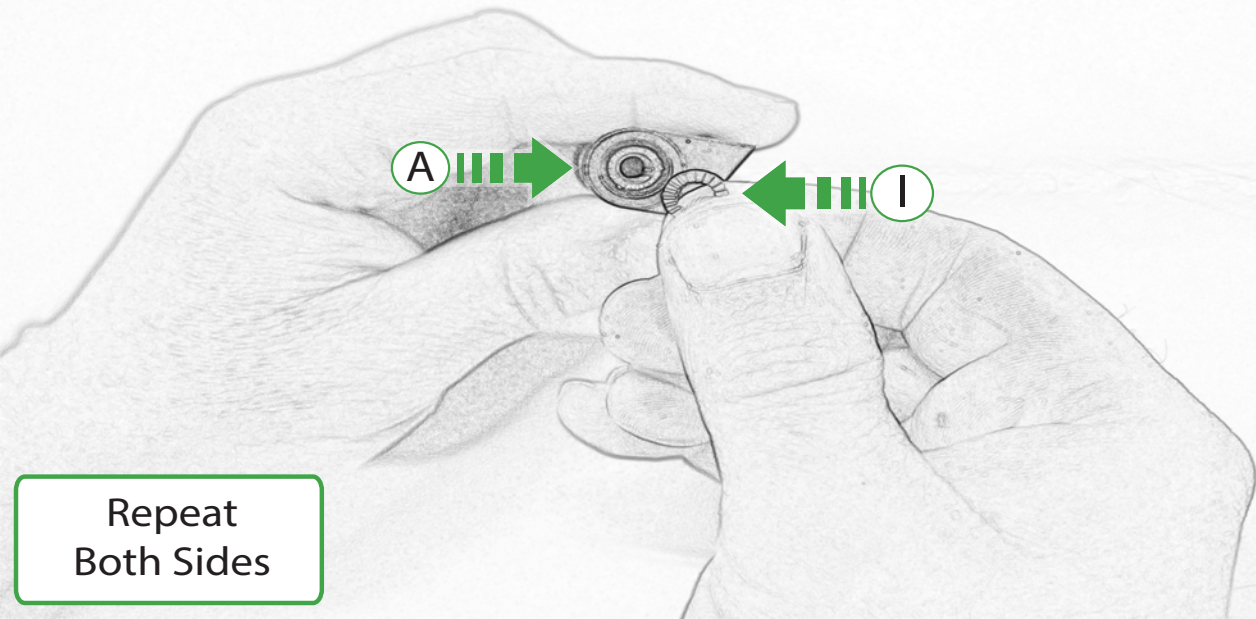

Repeat
Both Sides

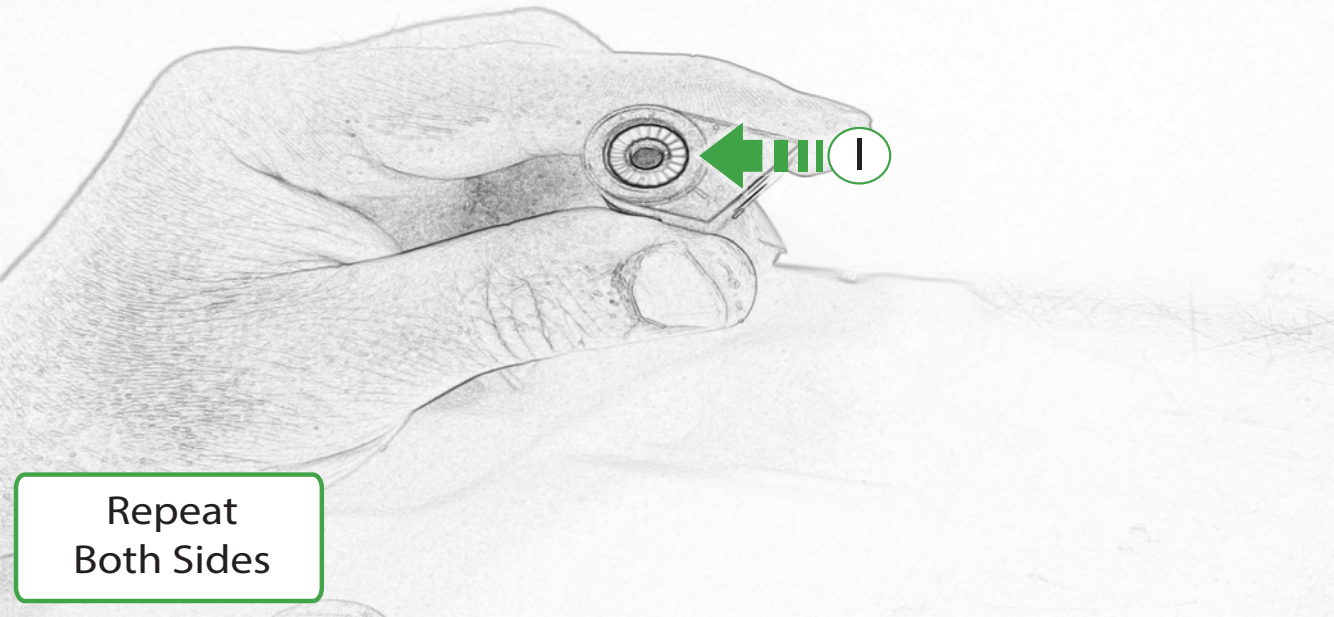

Repeat
Both Sides

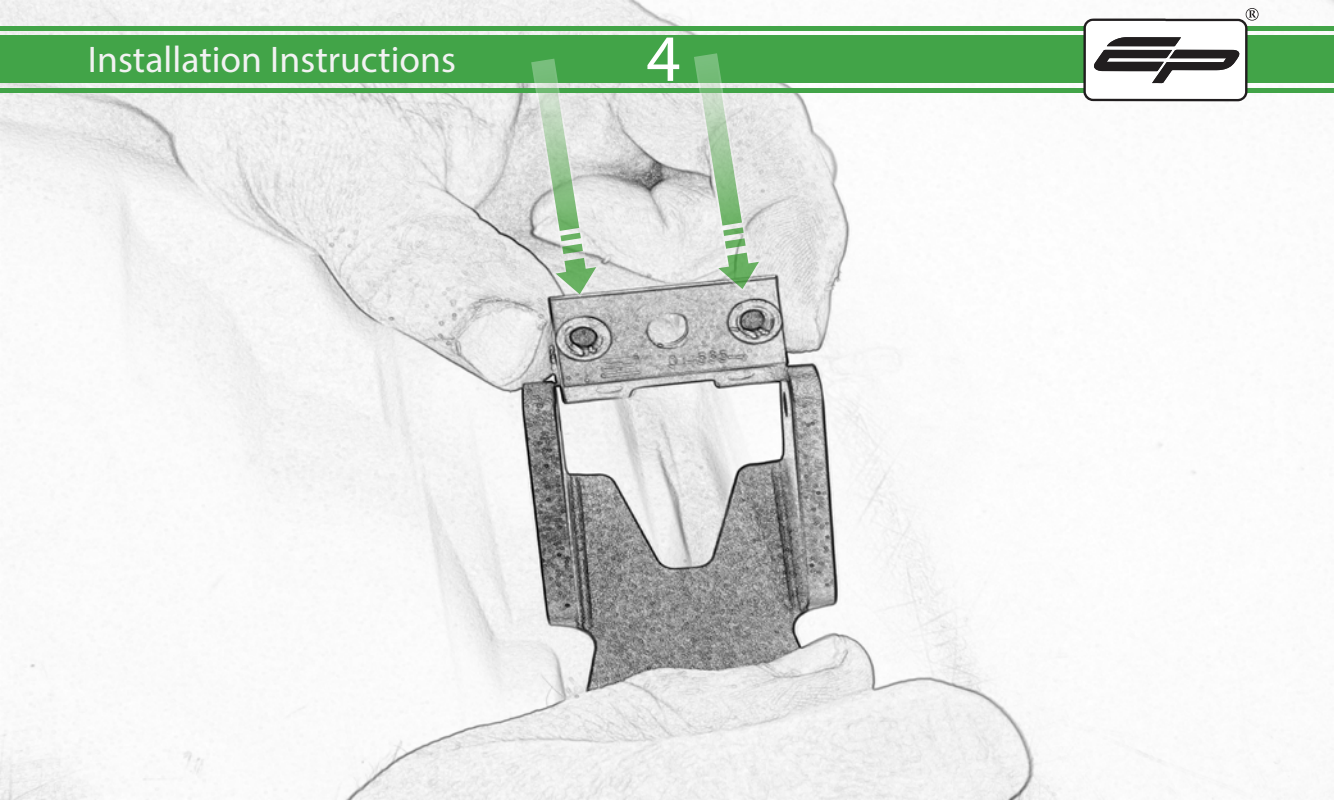

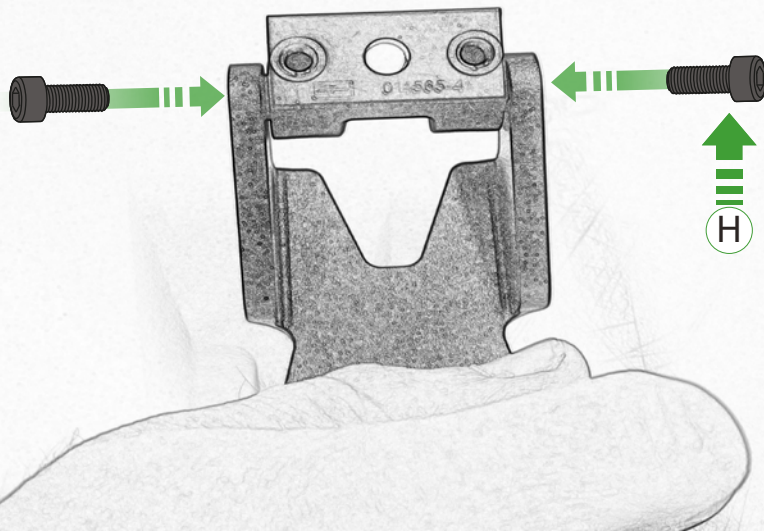

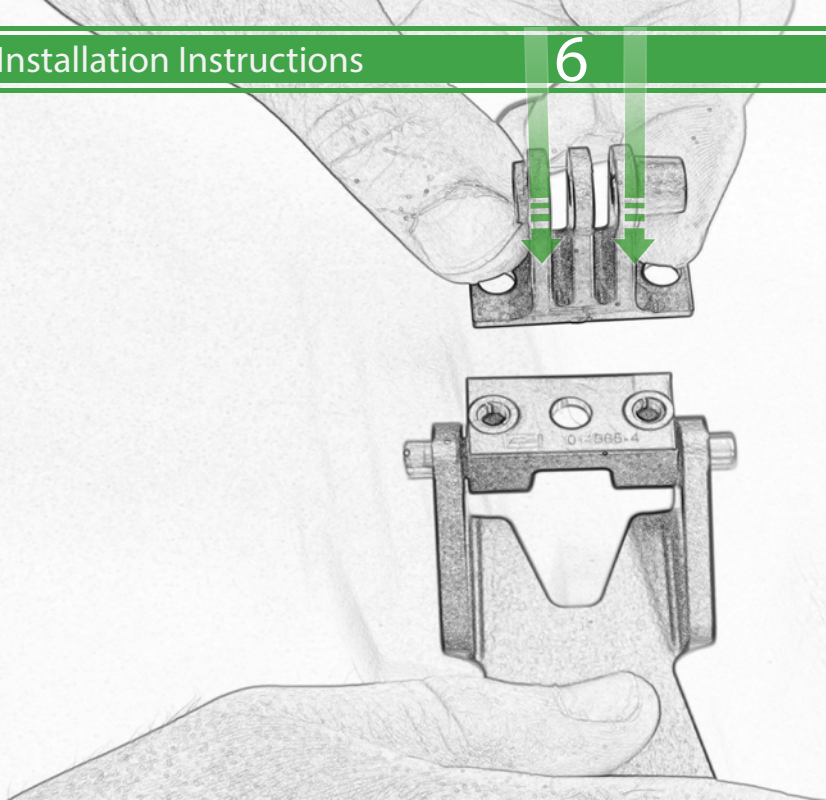

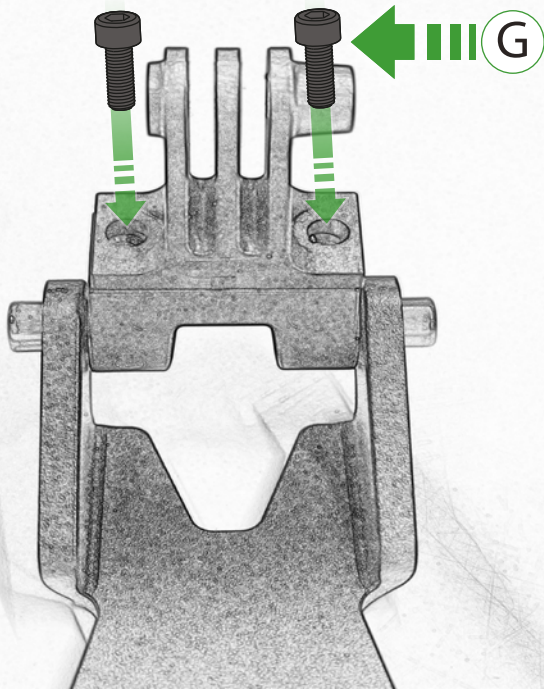

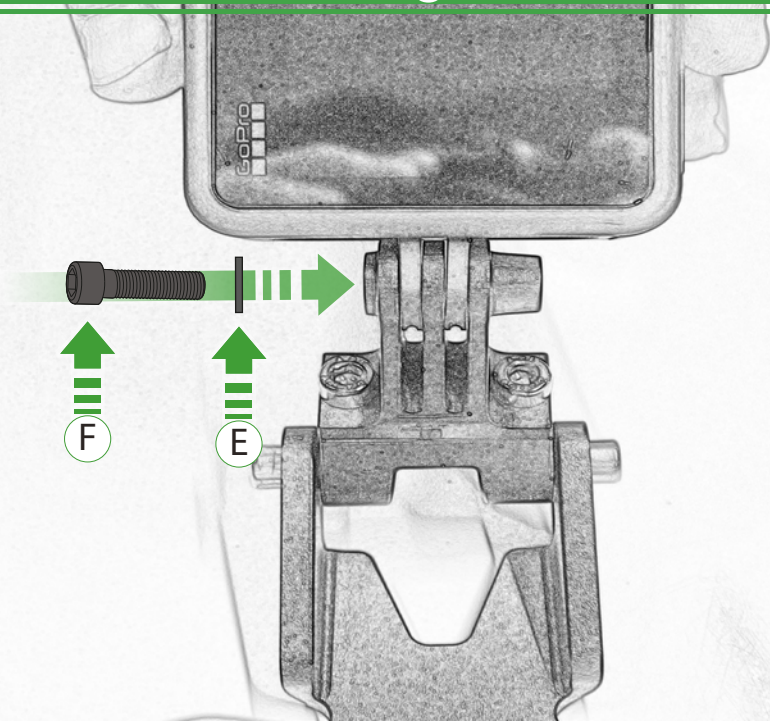

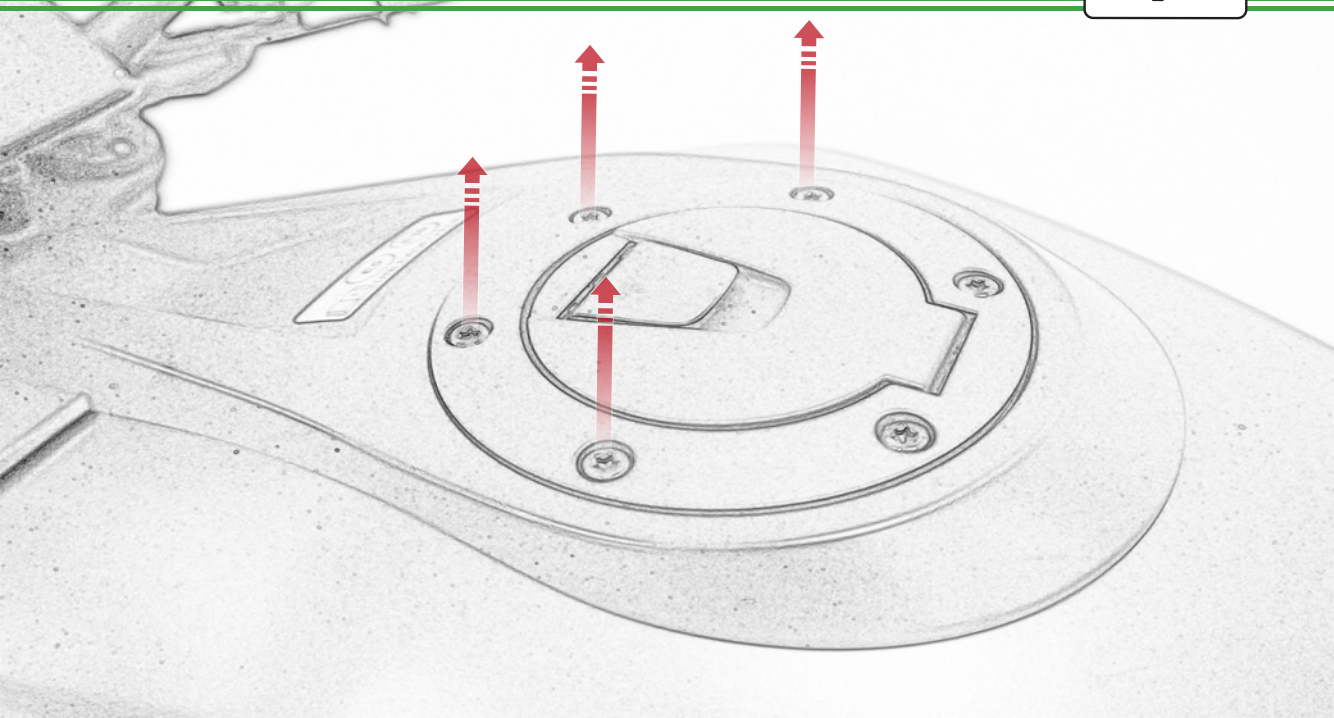

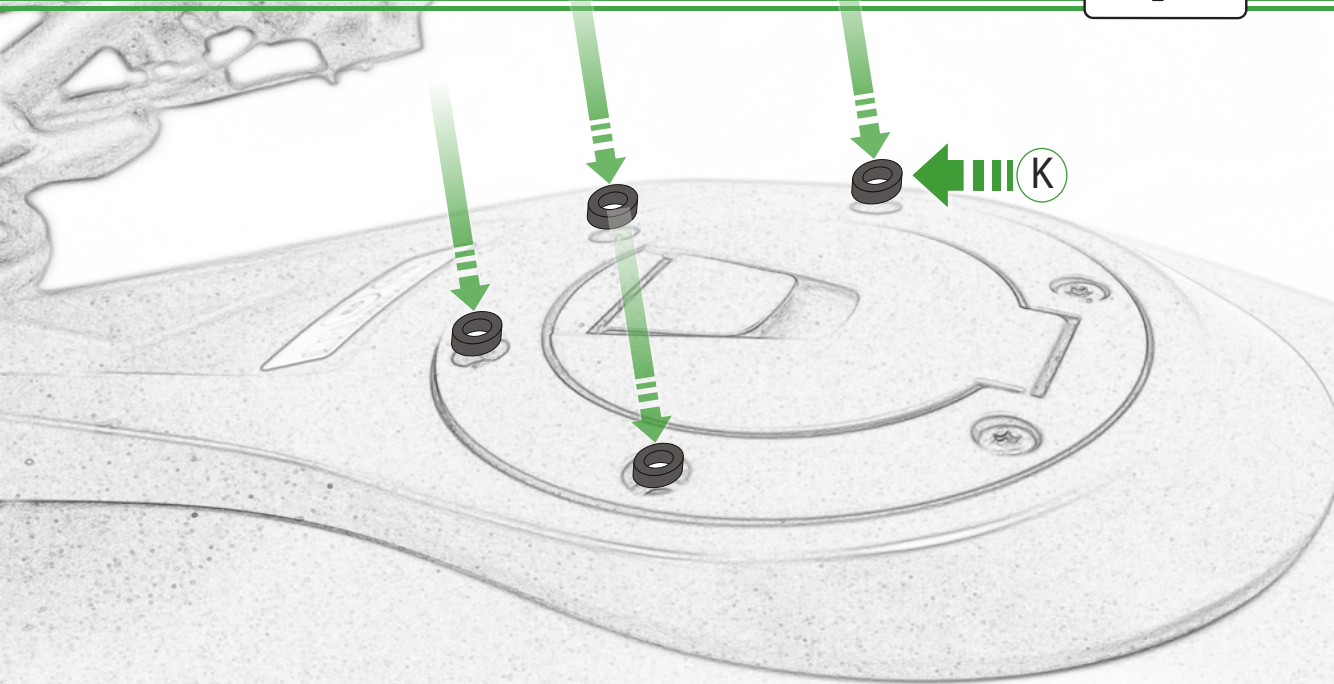

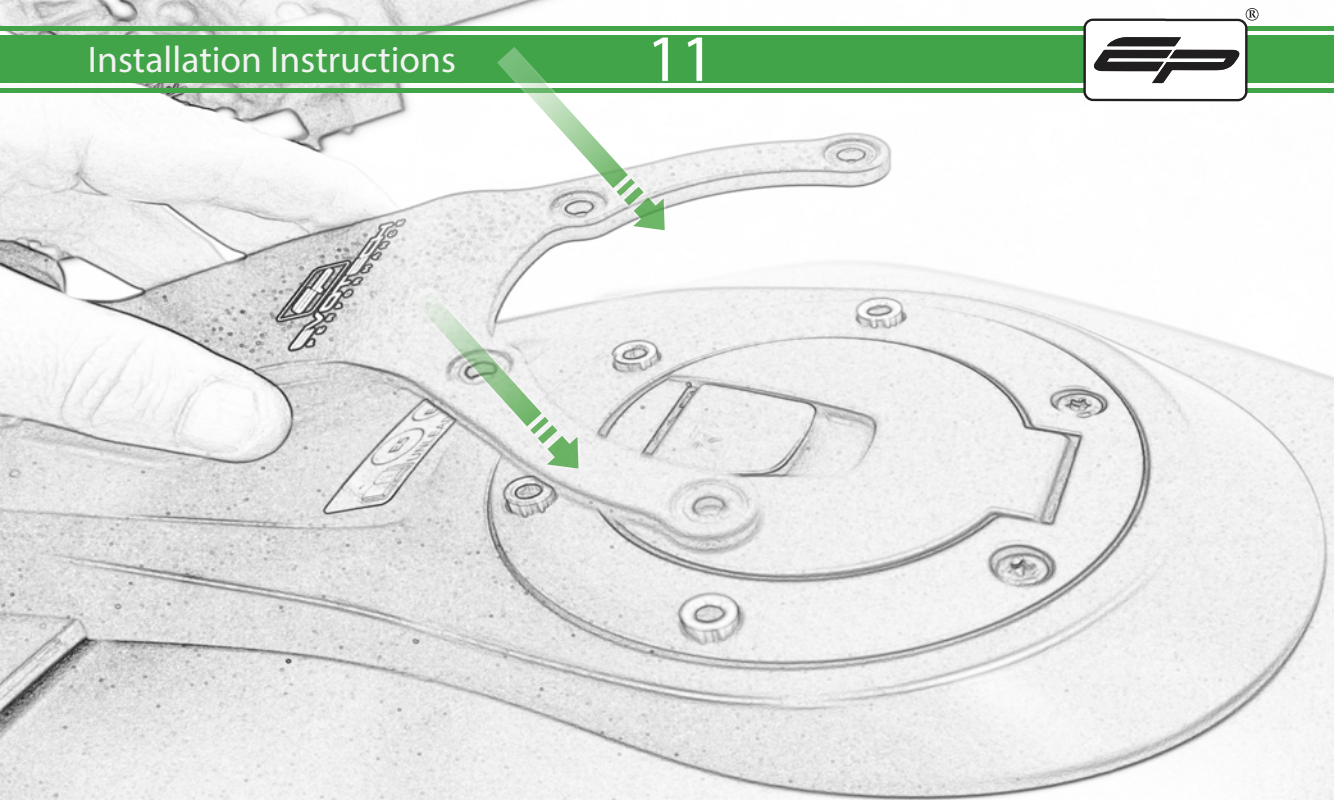

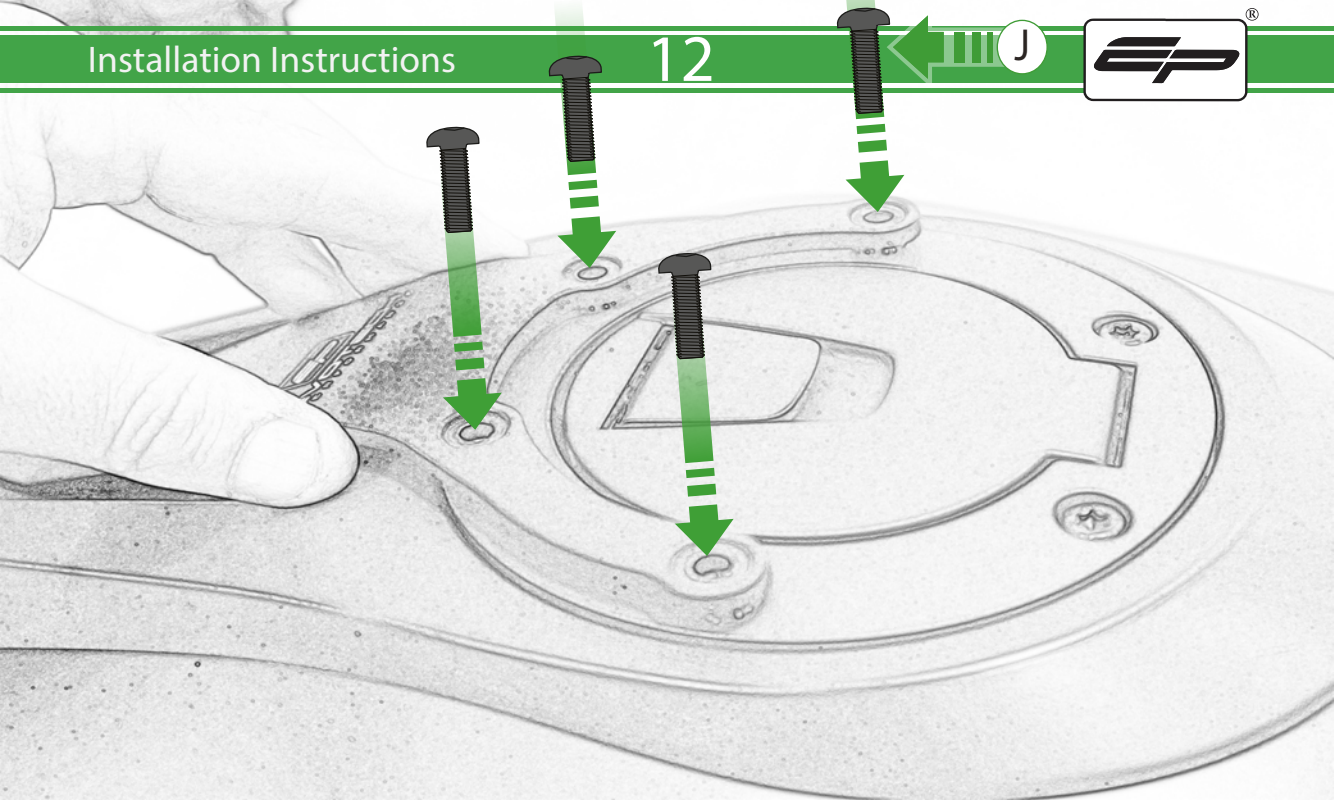



ESSENTIAL CHECKS



It is recommended that periodic inspections are made to ensure that all bolts are tightened to the specified torque settings.

Should the bike be involved in an accident a thorough inspection should be made and any components that have taken an impact, no matter how small, be replaced



EVOTECH®
P E R F O R M A N C E

www.evotech-performance.com