



**EVOTECH**®  
P E R F O R M A N C E

[www.evotech-performance.com](http://www.evotech-performance.com)

Triumph Sport 660  
Hand Guard Instruction



- Ⓐ 1 x Left Hand Bracket
- Ⓑ 1 x Left Hand Mirror Bracket
- Ⓒ 1 x Right Hand Bracket
- Ⓓ 1 x Right Hand Mirror Bracket
- Ⓔ 2 x Bar End Outer
- Ⓕ 2 x Bar End Middle
- Ⓖ 2 x Bar End Inner
- Ⓗ 2 x M6 x 35mm Caphead
- Ⓘ 4 x M5 x 16mm Black Button Head Bolts
- ⓵ 4 x M5 Black Washers

ERGOTEC<sup>®</sup>  
P E R F O R M A N C E

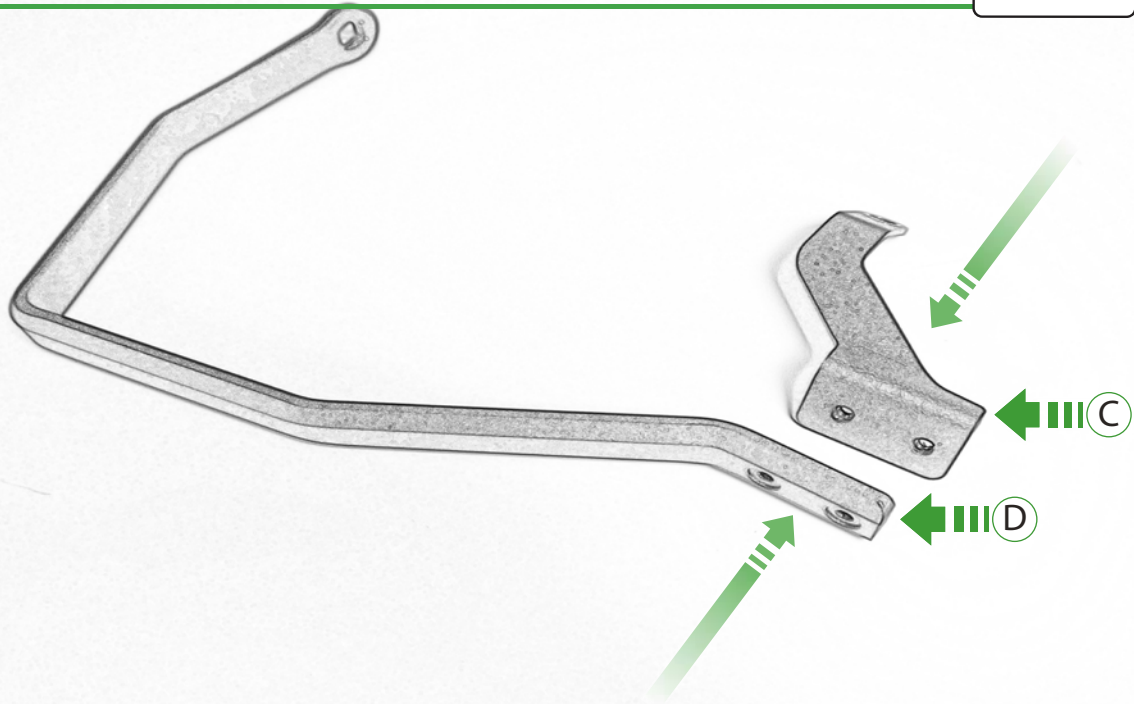

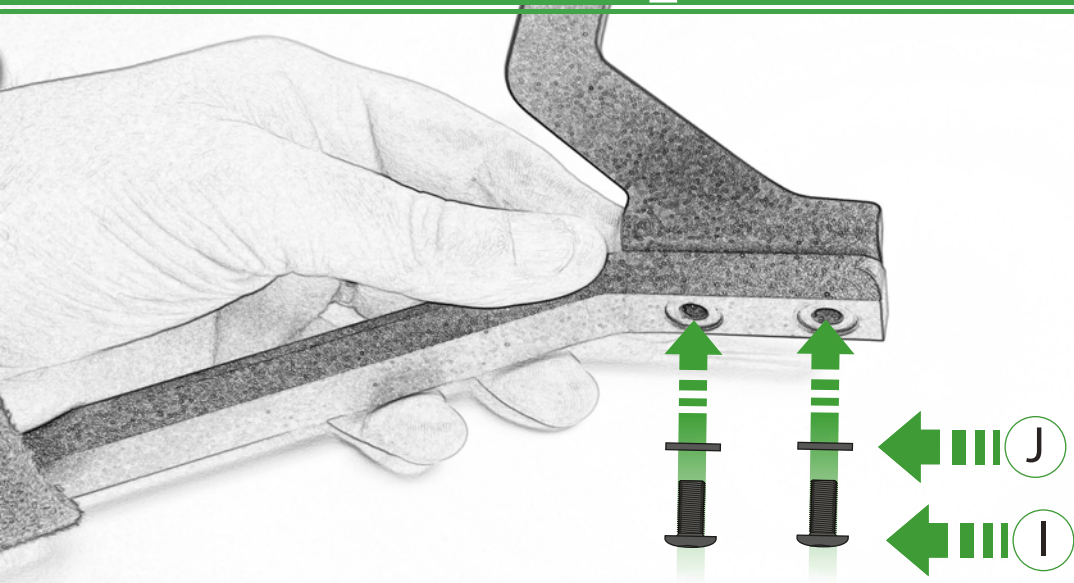

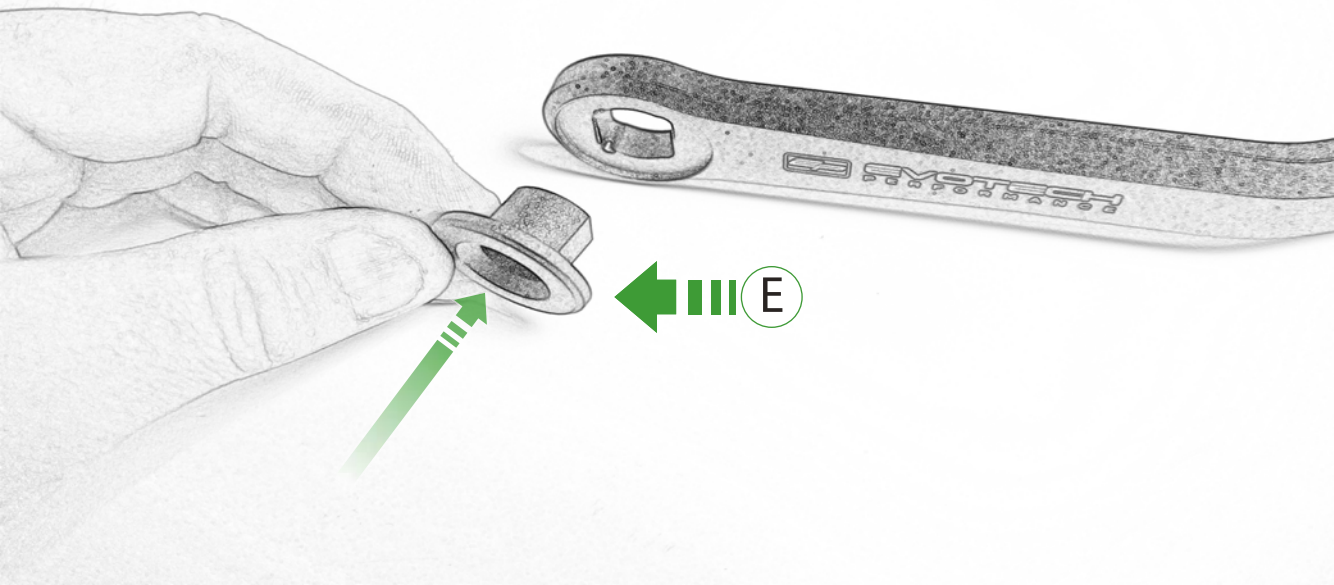

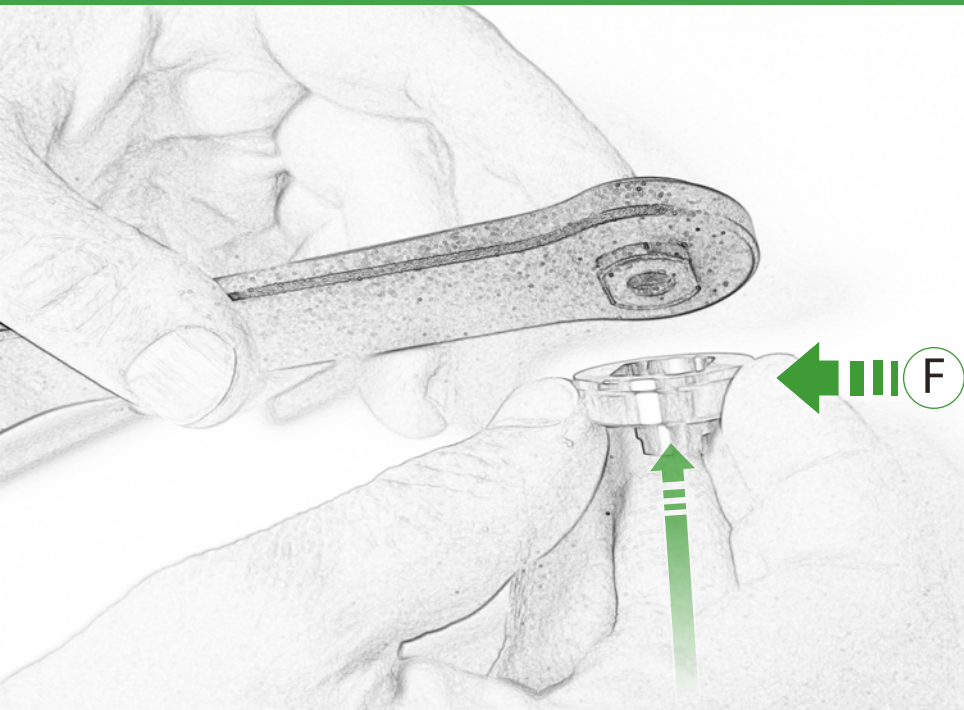

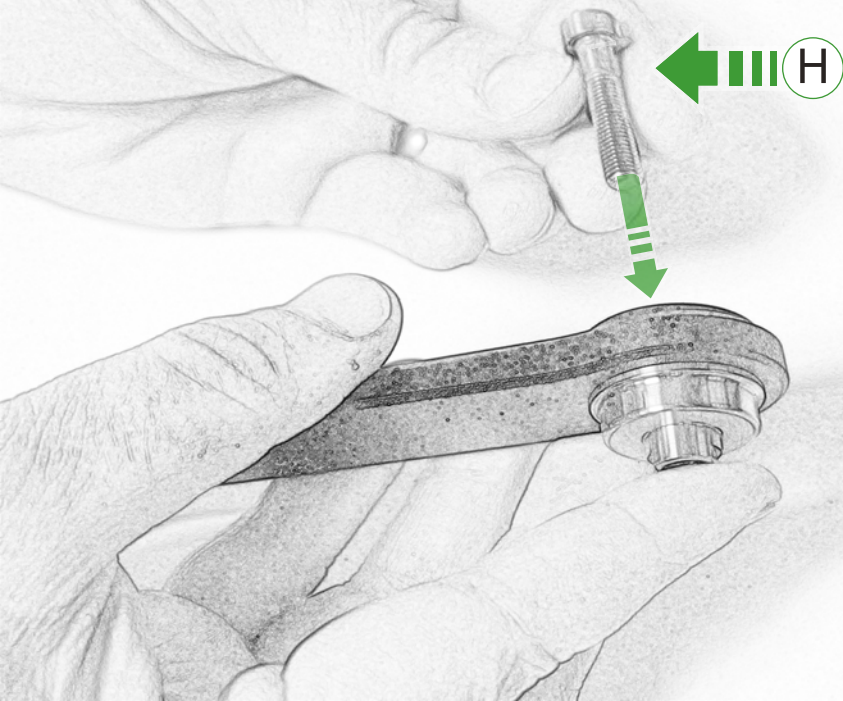

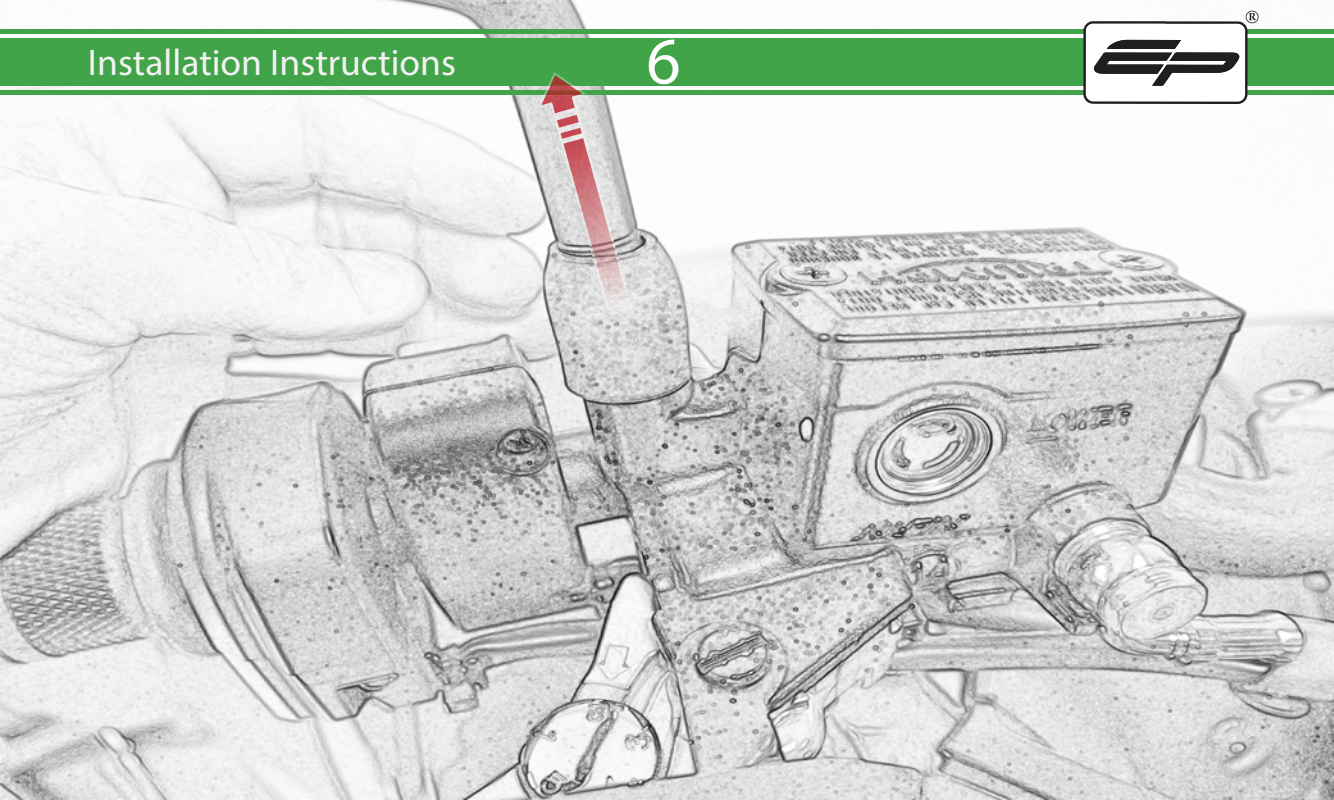

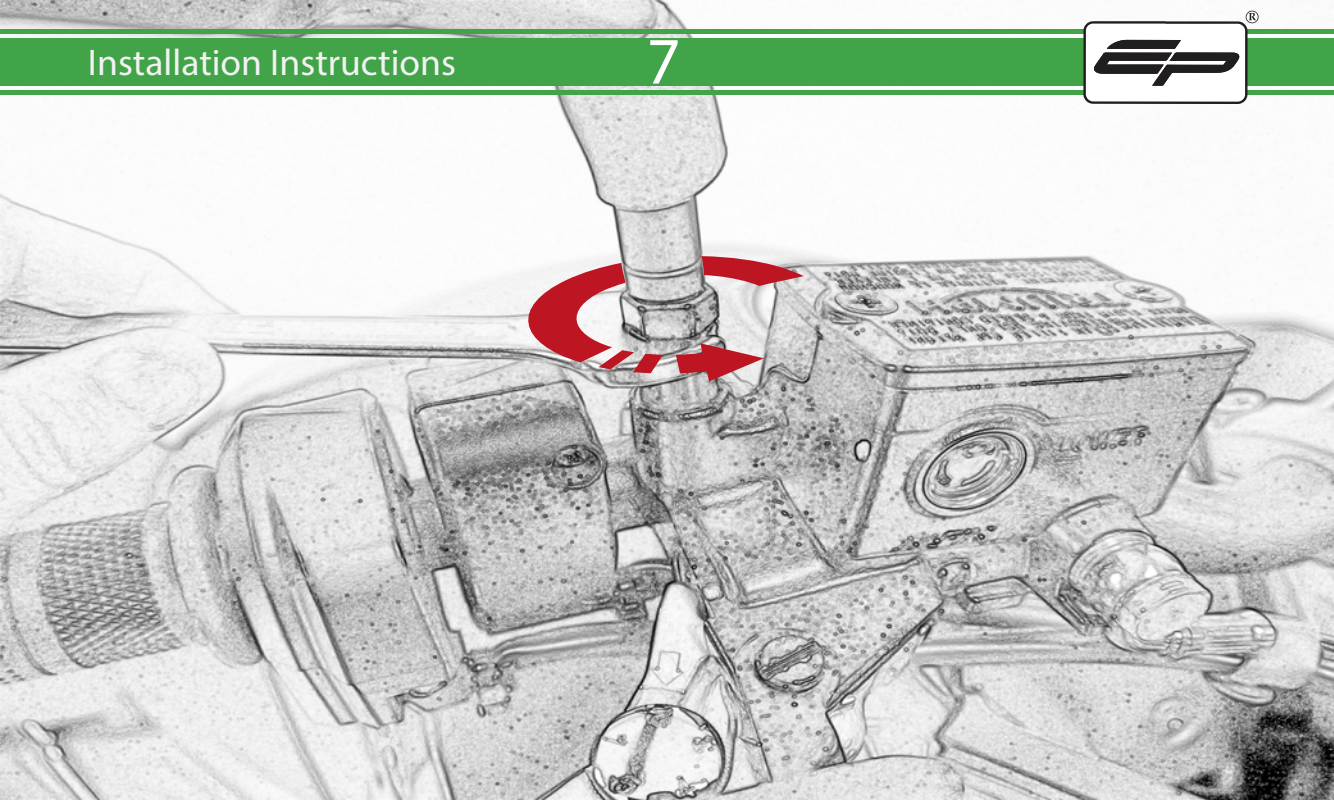

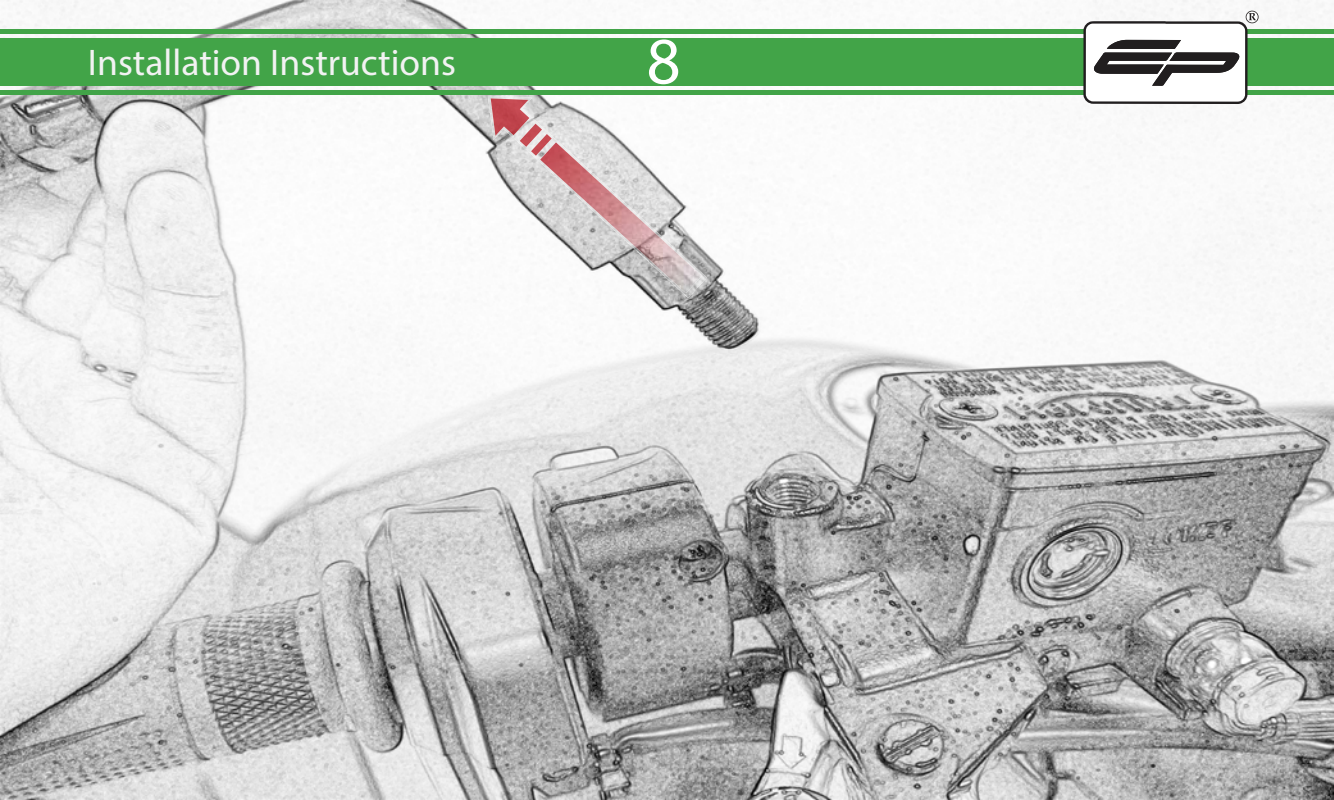

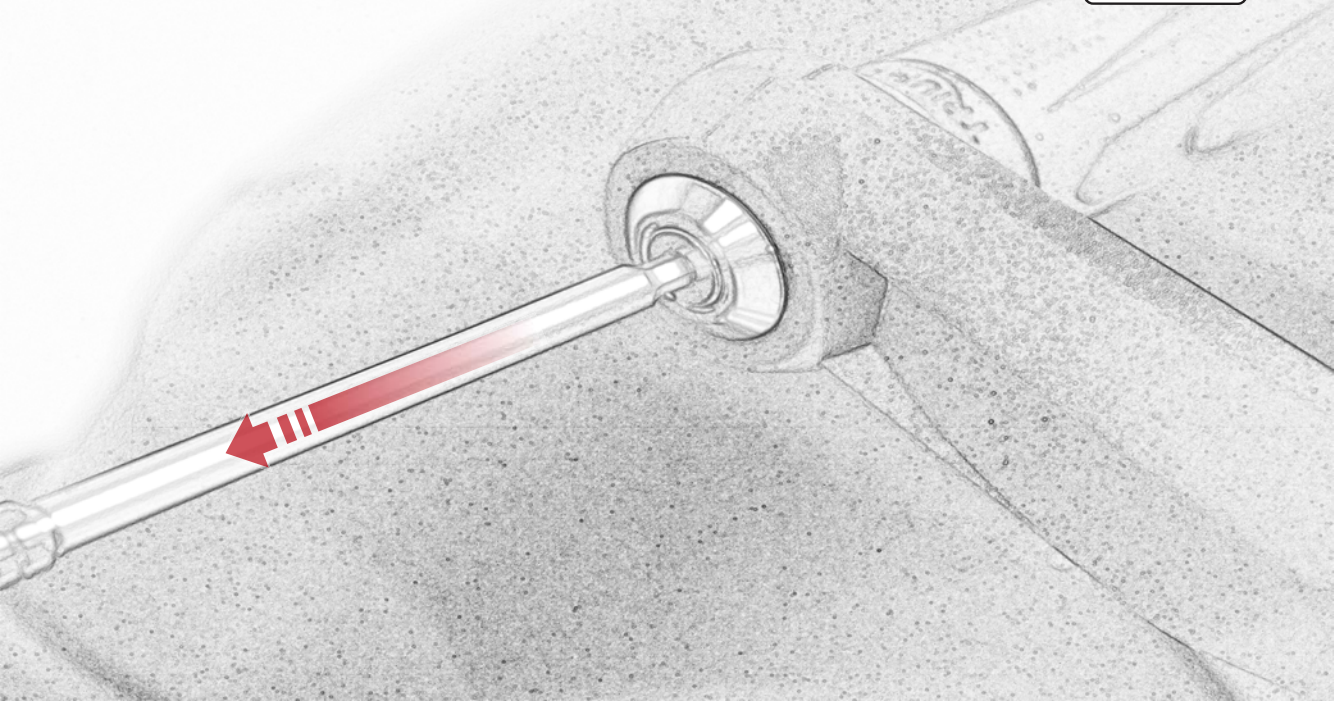



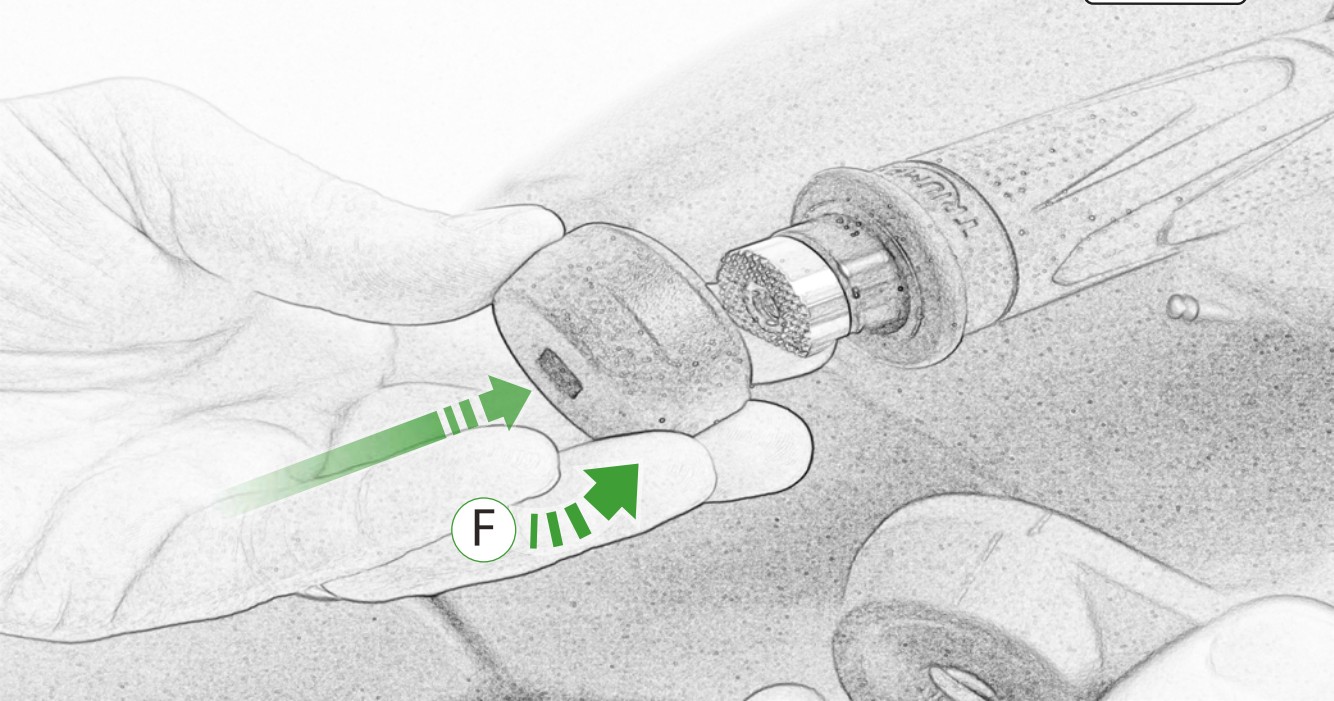

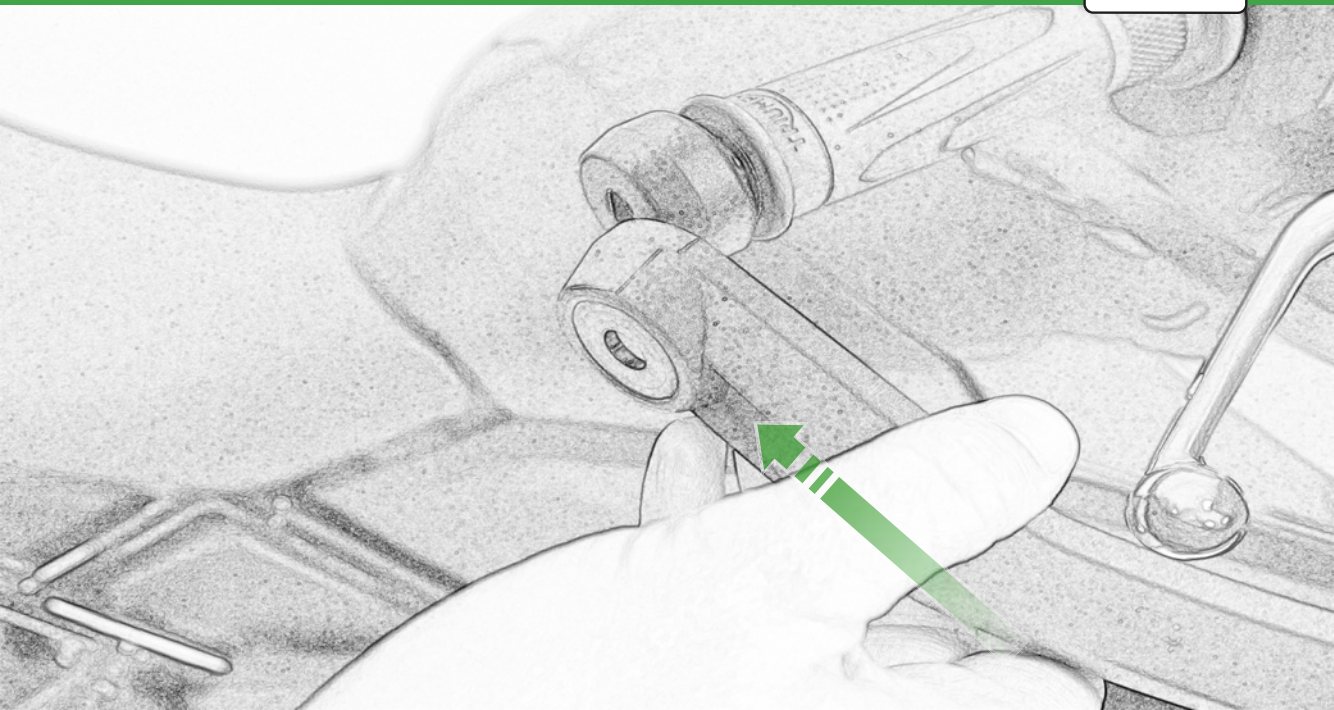

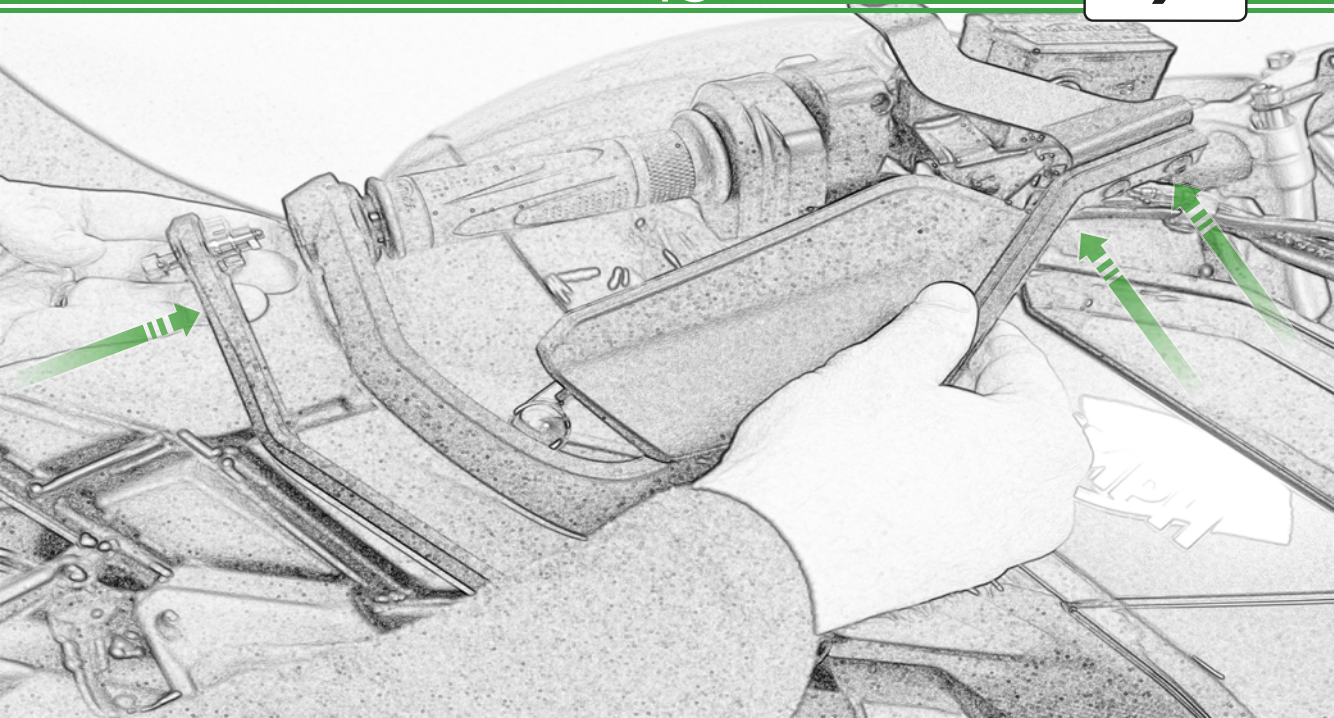

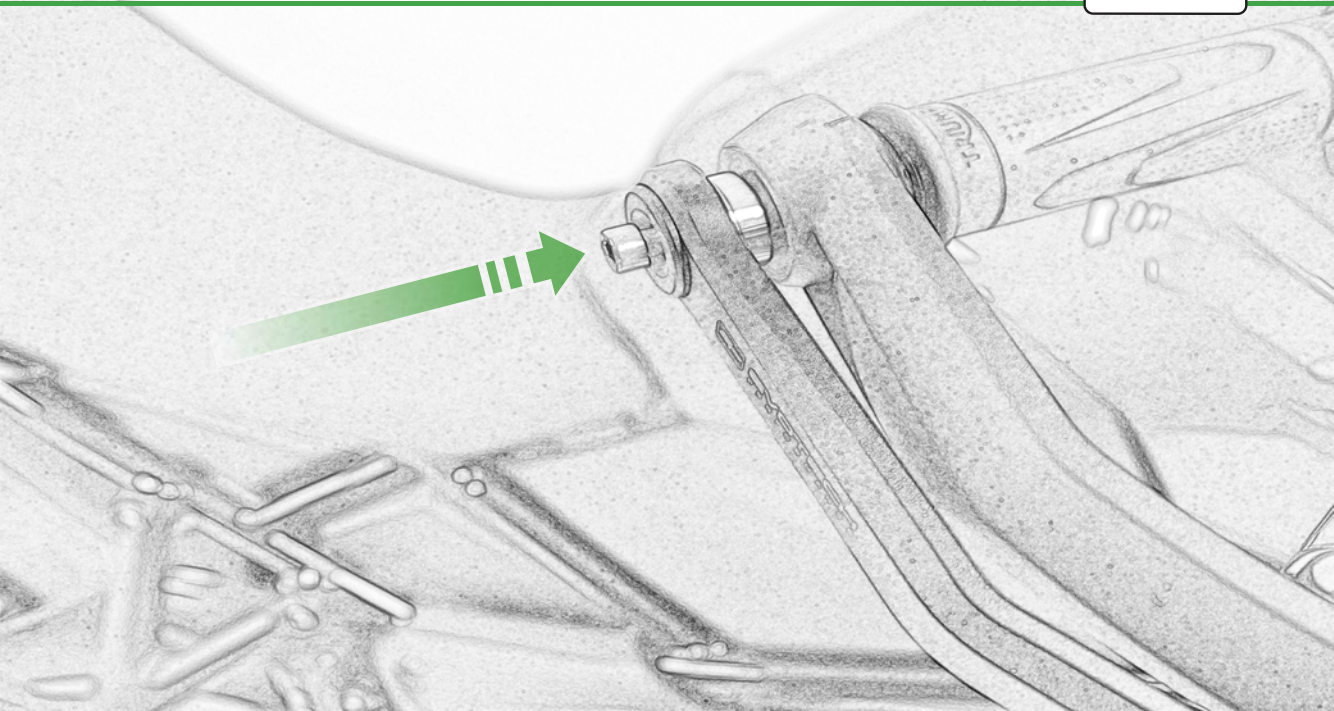



Rotate To Align  
Flats

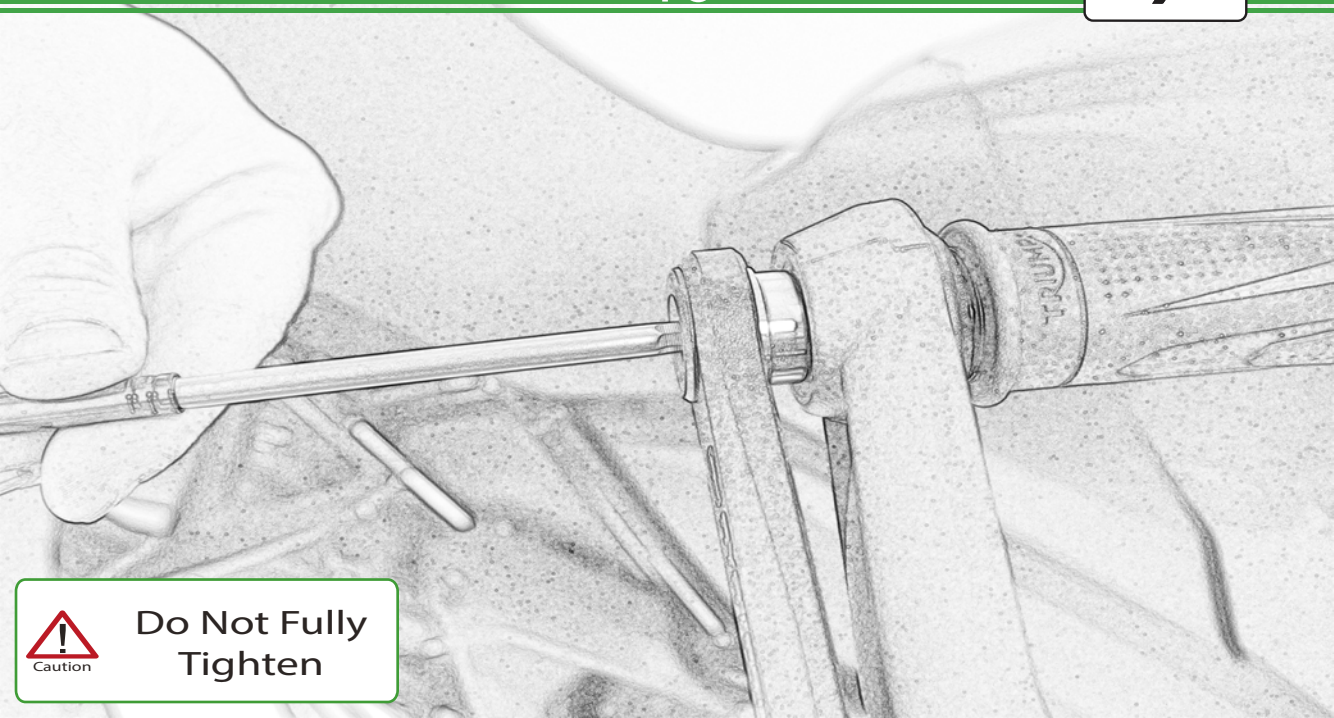

**Do Not Fully  
Tighten**

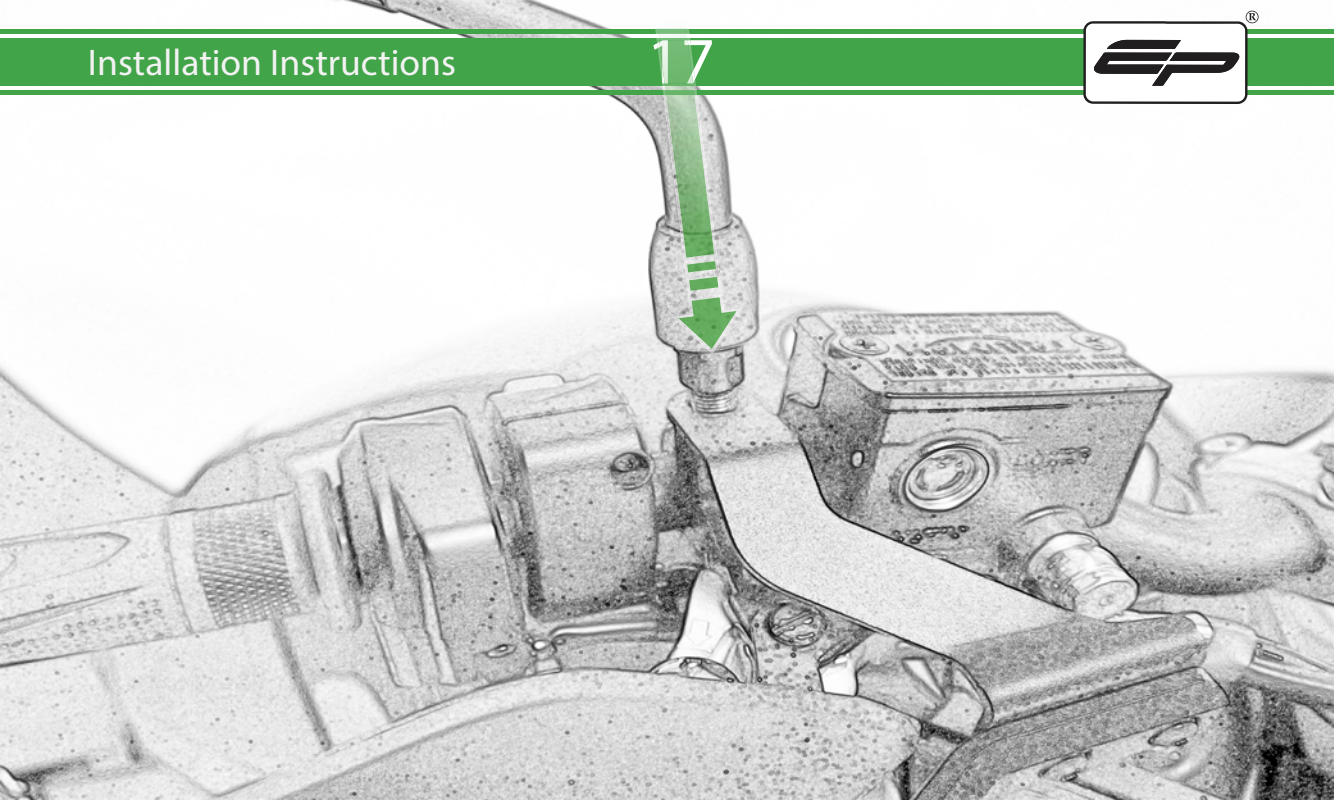

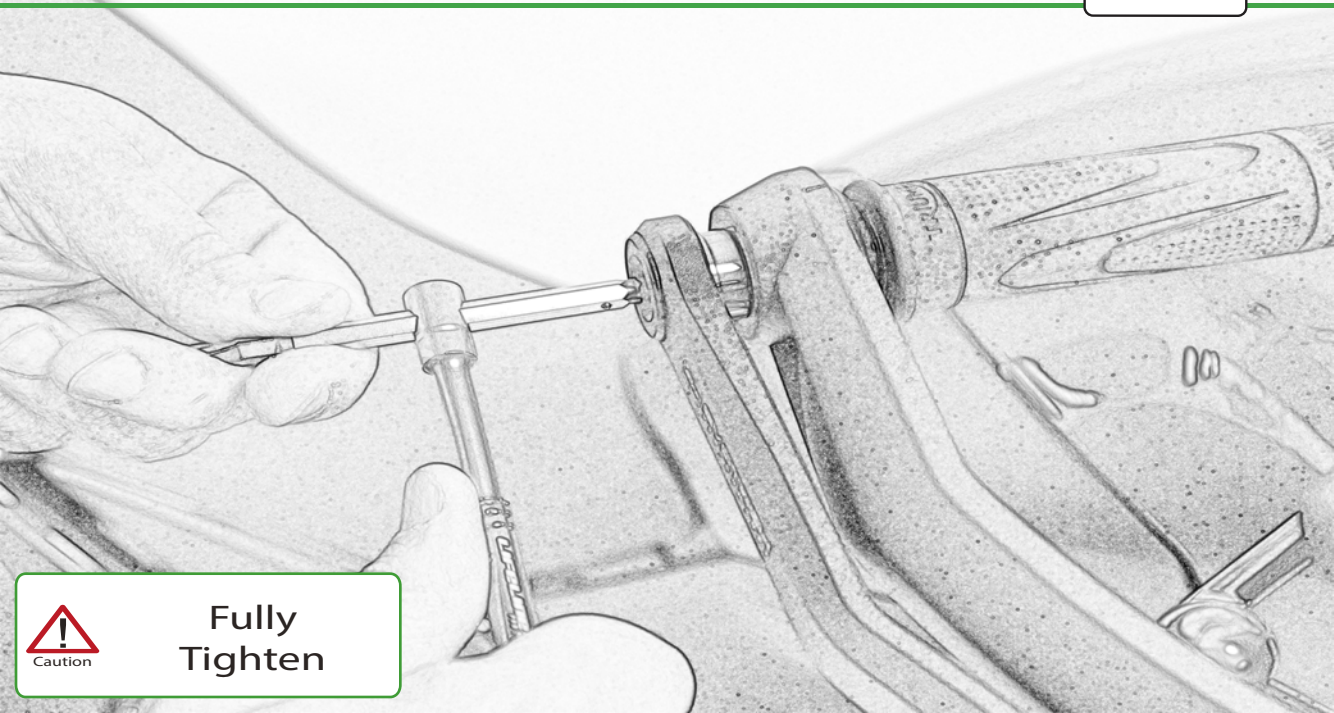

Fully  
Tighten

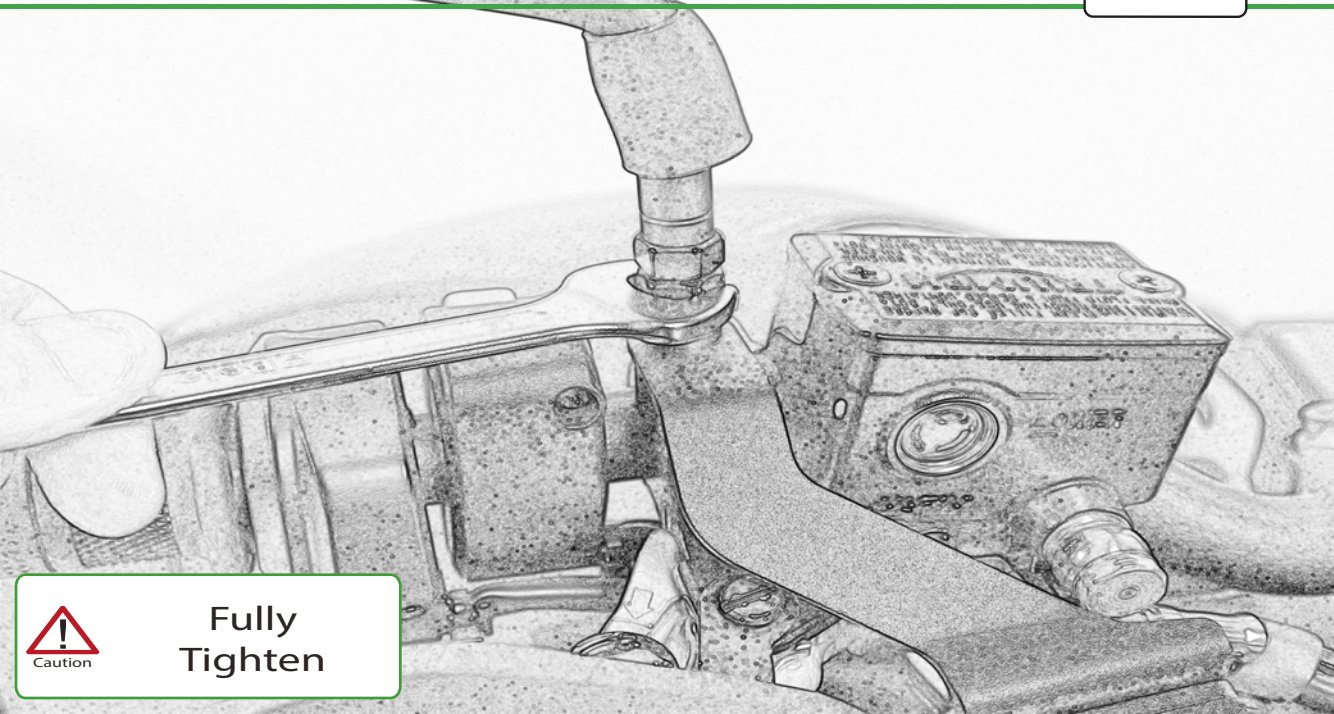

Fully  
Tighten



EVOTECH®  
P E R F O R M A N C E



## **ESSENTIAL CHECKS**

It is recommended that periodic inspections are made to ensure that all bolts are tightened to the specified torque settings.

Should the bike be involved in an accident a thorough inspection should be made and any components that have taken an impact, no matter how small, be replaced

P E R F O R M A N C E



**EVOTECH**®  
P E R F O R M A N C E

[www.evotech-performance.com](http://www.evotech-performance.com)